

**Rocky Mountain
Psychological Association
April 9-11, 2015**

**85th Annual Convention
Boise, Idaho**

TABLE OF CONTENTS

Thursday

Schedule of Events	14-15
Time Table of Events	16-17
Invited Speakers	18-19
Talks	20-24
Poster Session	25-26
Psi Chi Talks	27-28
Workshops	29

Friday

Schedule of Events	30-31
Time Table of Events	32-33
Invited Speakers	34-36
Paper Sessions	38-49
Poster Sessions	50-68
Psi Chi Events	69-71
Workshops	72
Symposia	73

Saturday

Schedule of Events	74-75
Time Table of Events	76-77
Invited Speakers	78-81
Paper Sessions	82-93
Poster Sessions	94-115
Psi Chi Events	116-117
Symposium	118
Workshops	119

Index of Participants	128-134
-----------------------	---------



GREETINGS FROM THE PRESIDENT LESLIE CRAMBLET ALVAREZ

Welcome to vibrant downtown Boise and the 85th Annual Convention of the Rocky Mountain Psychological Association. I am thrilled to serve this association as President and welcome you to a phenomenal meeting. Thanks to the work of our Executive Committee, numerous reviewers, speakers, and members, I am excited to share a top-notch three-day program with you.

This year's slate of nationally and internationally recognized speakers begins on Thursday with the Portenier/Wertheimer Teaching Conference. I hope you will join us for the yearly "Teaching Take-out" and Teaching Conference Keynote given by Dr. R. Eric Landrum, prolific author of teaching and learning scholarship and professor of psychology at Boise State. Thursday evening our main program kicks off with our opening speaker, Past President Dr. Charles Honts. Dr. Honts' talk will argue the role and responsibility of the profession of psychology in translating research, particularly within eyewitness testimony, false confessions and deceptive testimony, to practice.

On Friday, Tom Pyszczynski, world renown Terror Management expert, will deliver the Psi Chi Keynote. Members are invited to a conversation hour with Dr. Pyszczynski following his talk. In addition to numerous poster and oral presentation sessions throughout the day, our Presidential Address and Diversity Speakers are featured on Friday afternoon. Dr. Brian Nosek, co-leader of the Reproducibility Project will give this year's Invited Presidential Address. Following his talk he will host a workshop on Improving Openness and Reproducibility—bring your laptop! We are also pleased to welcome Dr. David Myers as this year's Worth and Diversity speaker. Dr. Myers will share both the personal and scientific side of hearing and hearing loss including assistive technology innovations.

Saturday is chock-full of exciting programming including the third annual RMPA Alumni Address. This year's speaker is Dr. William

"Doug" Woody. The RMPA Distinguished Lecture will be given by Dr. Erin Bigler, expert in neuropsychology, neuroimaging and neurodevelopmental disorders. His talk will explore the integration of neuroimaging methods in the study of cognition and behavior. Saturday afternoon we welcome Dr. Lori James, memory and language researcher from the University of Colorado, Colorado Springs. Dr. James will be sharing with us "The Story of HM." Wrapping up a dynamic day, Dr. Stanley Coren will be giving the Gardner Memorial Lecture on the intelligence of dogs.

As always, we hope you will be pleasantly overwhelmed by an amazing slate of speakers and the many concurrent sessions offered throughout each day. Personally, I take enormous pride in RMPA's reputation for being a student-friendly, collegial, and welcoming convention. Please take advantage of the opportunity to connect (or reconnect) with friends and colleagues at the social events and luncheon meetings.

Finally, none of this would be possible without an amazing group of people who work year-long to make this convention great. I would like to thank Nancy Karlin, Convention Coordinator, for her tireless work securing and arranging our facilities and James Kole for his "trial by fire" year taking over as Program Chair from Diane Martichuski. I would also like to offer my sincere gratitude to the rest of the Executive Committee, President-Elect: Michelle A. Butler, Past President: Steve Barney, Secretary: Bob Rycek, Treasurer: Cheryl Sanders, Diversity Council Chair: Anna Ropp, Archivist/Historian: Rick Miller, Teaching Conference Coordinator: William "Doug" Woody and our intrepid Convention Managers: Teresa Taylor and Kim Hardy from Boise State. I would also like to recognize Susan Becker, Regional Vice President of Psi Chi, Aaron Richmond and the STP, and APA for their support of this convention. If you see one of these individuals, please offer your thanks as well! Lastly, thank you for your membership and support of this association. RMPA would not exist without you! I hope you find this year's convention inspiring and enriching.



A very warm welcome,

Leslie

Leslie Cramblet Alvarez

President, Rocky Mountain Psychological Association



Join Us for a Year-Long
 Celebration of Our
85th Anniversary



Ten Reasons to Celebrate Membership in Psi Chi

1. International recognition for academic excellence in psychology
2. Over \$400,000 in awards and grants
3. Three great publications—*Eye on Psi Chi*, *Psi Chi Digest*, and *Psi Chi Journal of Psychological Research*
4. Chapter involvement—leadership experience, valued friendships, personalized education, mentoring, and community service
5. Networking opportunities at local, regional, national, and international conventions
6. Graduation regalia, apparel, and more
7. Lifetime membership
8. Social media connections
9. Membership card and certificate
10. U.S. government qualifier for GS-7 entrance level positions

building
 relationships that
 advance psychology

WWW.PSICHI.ORG

Stay connected with PSI CHI



TRANSFORMING PASSION INTO PURPOSE

Interested in becoming a school psychologist?

Two years in a row, U.S. News & World Report lists School Psychology as a top career, and there is a great and growing need for school psychologists in the Rocky Mountain Region.

The Morgridge College of Education's Child, Family, and School Psychology program:

- Offers PhD and EdS degrees accredited by the National Association of School Psychologists (NASP)
- Develops highly competent, collaborative, ethical, and self-reflective scientist-practitioners
- Prepares students to work on behalf of individuals, families, schools, and communities

Learn more at morgridge.du.edu/programs



UNIVERSITY of
 DENVER

MORGRIDGE COLLEGE OF EDUCATION



Graduate Programs
University of Wyoming

PSYCHOLOGY



Clinical Psychology

Social Psychology

Cognition/Cognitive
Development

Psychology and Law

Earn your Ph.D. in Psychology at the University of Wyoming:

- Small, friendly, excellent program in the mountain west
- Clinical training is APA-accredited, scientist-practitioner model
- Extensive research and collaboration opportunities
- Excellent record of post-graduation employment
- Typically, students receive full support for at least 4 years

Program and application information:

<http://www.uwyo.edu/psychology/graduate/>

GENERAL INFORMATION

Location

All regular meetings will be held at The Grove Hotel (208-333-8000). Most meetings are in the conference rooms on the second and third floors of the hotel. Please consult the signs throughout the first and second floors of The Grove Hotel for each day's events with rooms and times.

Information and Messages

A bulletin board for messages and announcements is located near the registration tables on the second floor. Please feel free to use it to communicate with your colleagues.

Internet Access

The Grove Hotel offers high speed, wireless internet access throughout the hotel. There is a Business Center in the hotel that is free for the use of registered guests.

Handicapped Access

All conference rooms at The Grove Hotel are handicapped accessible. The restaurant, bar, and lavatories are also handicapped accessible. Persons needing special accommodations should inquire at the conference registration tables and should make their needs known to the hotel during check-in.

Exhibitors

The exhibits are all located in the Evergreen Room, along with the poster sessions (except for Thursday's poster session, which is located in the Aspen/Cedar rooms). A list of all exhibitors is provided in this program. Exhibitors provide support for the RMPA convention and the best way to say "thank you" is with your patronage.

Smoking

The Grove Hotel is a non-smoking facility. However, there is an open air terrace on the second floor where smoking is permitted.

Registration

On-site registration will begin at 7:00 p.m. on Wednesday. The registration desk is located on the second floor of The Grove Hotel near the conference rooms. Admission to the convention sessions is only available to those who register.

Please wear your identification badge to ensure admission to the scheduled program activities. Registration times are as follows:

Wednesday:	7:00 pm – 10:00 pm	Friday:	7:30 am – 4:30 pm
Thursday:	8:00 am – 9:00 pm	Saturday:	7:30 am – 11:30 am

(continued on page 9)



Idaho State UNIVERSITY

**The Department of Psychology
at Idaho State University is committed to
quality research and teaching.**

Our faculty's areas of expertise include clinical, cognitive, social, developmental, personality, learning, physiological, comparative, and behavioral pharmacology.

We offer a Bachelor of Arts and Bachelor of Science in psychology, a Doctor of Philosophy in experimental psychology, and Doctor of Philosophy in clinical psychology.

Faculty emphasize mentoring undergraduate and graduate students. Faculty members are actively involved in research that is designed to provide students an opportunity to collaborate with faculty on a diverse array of research projects.

discover
OPPORTUNITY

Find out more at <http://www.isu.edu/psych/>

GENERAL INFORMATION CONTINUED...

On-site registration fees

Lifetime members:	\$75.00
Members:	
Dues paid:	\$75.00
Dues not paid:	\$110.00
Non-members:	\$135.00
Students/Affiliates* (members):	
Dues paid:	\$60.00 (student ID required on-site)
Dues not paid:	\$75.00 (student ID required on-site)
Students/Affiliates (non-members):	\$90.00 (student ID required on-site)
Dependents/sig. others**	\$25.00

*students, high schoolteachers, and non-PhD attendees
**not psychologists or psychology students

Membership:

The yearly dues are \$35.00 (Paypal) or \$40.00 (check) for members and \$15.00 (Paypal) or \$20.00 (check) for affiliates which includes undergraduate and graduate students as well as secondary school teachers. Non-members who register at the meeting and who wish to join RMPA can get an application form at the registration tables. Member application forms can be obtained at any time during the year from the RMPA website at <http://www.rockymountainpsych.org>. There is no geographical restriction on membership.

Convention Protocol

The majority of papers presented at RMPA are authored by students. For some of you, this may be your first convention. Welcome aboard! To fully appreciate the experience, here are some guidelines you might find useful.

- We will try to maintain the program schedule. If presenters are absent, the session will not move other presenters forward in the timetable. Thus, you are assured to hear the presentations you want to attend.
- Enter and exit in-progress sessions quietly and inconspicuously (if necessary).
- When you are in an area where a session is not occurring, other sessions may be going on nearby. Please keep the noise down, even in hallways.
- Always respect others' opinions. Questions can challenge, but should not confront or demean. Constructive criticism is good, but remember what you learned in kindergarten about common courtesy and good manners.
- Mingle. It is always difficult to introduce yourself to "strangers", but all of the participants are interested in Psychology and have a lot in common. This is an opportunity to grow in your chosen field by discussing topics of interest and making contacts with persons at other institutions.

RMPA Executive Committee 2014-2015

President:
LESLIE CRAMBLET ALVAREZ
 Adams State University
 Alamosa, CO 81102
 lcramblet@adams.edu

President-Elect:
MICHELLE BUTLER
 USAF
 michellebutler200@gmail.com

Past-President:
STEVE BARNEY
 Southern Utah University
 Cedar City, UT 84720
 barney@suu.edu

Secretary:
ROBERT RYCEK
 University of Nebraska at Kearney
 Kearney, NE 68849
 rycekr@unk.edu

Treasurer:
CHERYL E. SANDERS
 Metro State Univ. of Denver
 Denver, CO 80217
 sandersc@msudenver.edu

Diversity Council Chair:
ANNA ROPP
 Metro State Univ. of Denver
 Denver, CO 80217
 aropp@msudenver.edu

Program Chair:
JAMES KOLE
 University of Northern Colorado
 Greeley, CO 80639
 james.kole@unco.edu

Archivist/Historian:
RICHARD L. MILLER
 Texas A&M University-Kingsville
 Kingsville, TX 78363
 richard.miller@tamuk.edu

Convention Coordinator:
NANCY J. KARLIN
 University of Northern Colorado
 Greeley, CO 80639
 nancy.karlin@unco.edu

Teaching Conference Coordinator:
WILLIAM DOUGLAS WOODY
 University of Northern Colorado
 Greeley, CO 80639
 william.woody@unco.edu

Convention Co-Managers:
TERESA TAYLOR
 Boise State University
 Boise, ID 83725
 teresataylor@boisestate.edu

and

KIMBERLY HARDY
 Boise State University
 Boise, ID 83725
 kimhardy@boisestate.edu

MAP OF MEETING ROOMS

2ND FLOOR MEETING ROOMS

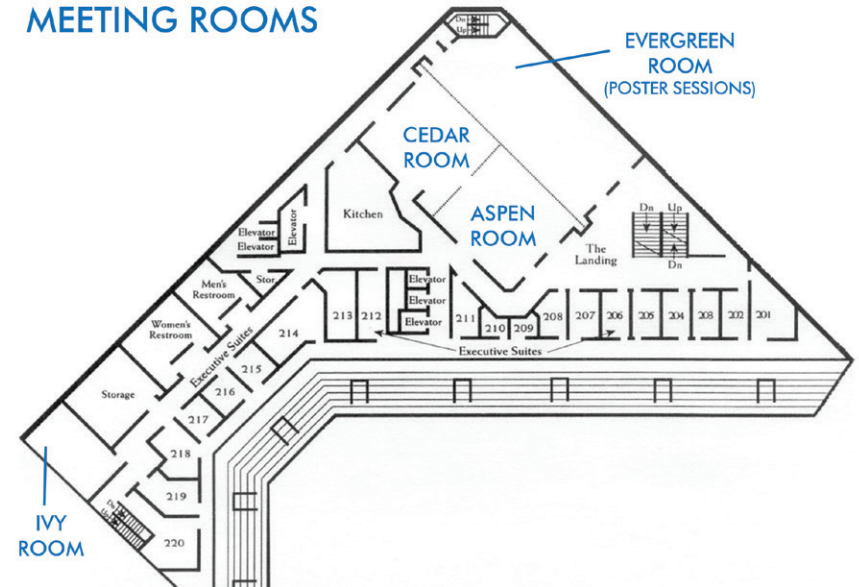

3RD FLOOR MEETING ROOMS

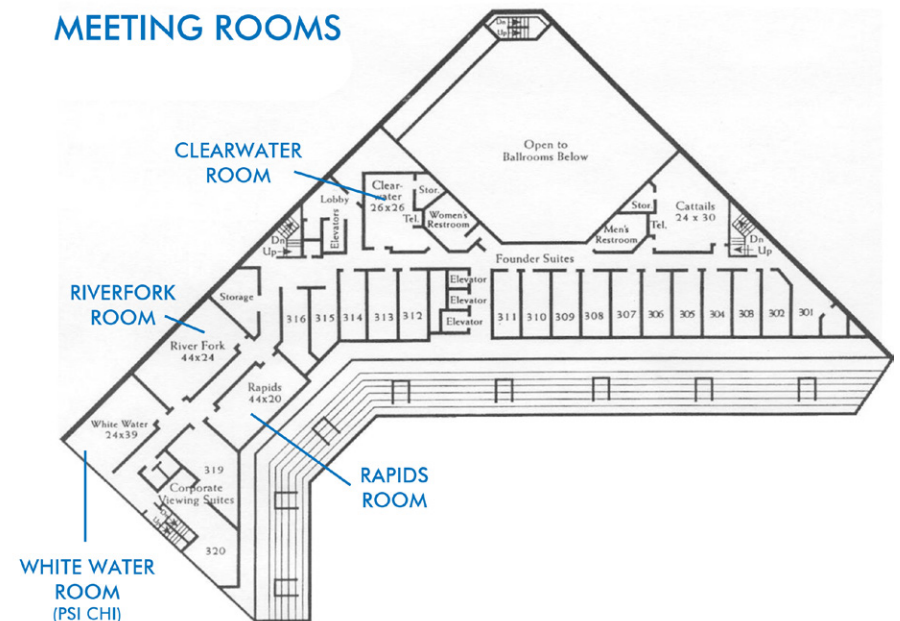

PORTENIER/WERTHEIMER TEACHING CONFERENCE

**RMPA would like to thank the
APA Education Directorate and the
Society for the Teaching of Psychology
for their sponsorship of this conference.**

PURPOSE OF THE TEACHING CONFERENCE

The teaching conference is designed for faculty who teach at four-year universities and colleges, community colleges, and high schools. Specifically, it is for those who wish to explore new ideas that will enhance and broaden their teaching skills. This celebration of teaching will provide useful and interesting information directly related to teaching psychology and the opportunity to see award-winning teachers in action. The teaching conference will also provide a forum for the discussion and exchange of knowledge and practice about the teaching of psychology as well as student learning and assessment.

WHO SHOULD ATTEND

- Psychology teachers (colleges, universities and high school)
- Researchers in the teaching of psychology
- Support staff and developers working with psychology teachers
- Developers and publishers of psychology resources



LILLIAN PORTENIER

In 1995, Lillian Portenier received the first “Outstanding Former Faculty Award” from the University of Wyoming. A professor of psychology when she retired in 1961, she was dedicated to undergraduate psychology majors. Dr. Portenier joined the University of Wyoming as a Mathematics instructor in 1925 after receiving an A.M. degree from the University of Nebraska. She became an assistant professor of psychology in 1930 and after earning a Ph.D. from Columbia University in 1933, received promotions to full professor. During World War II, she was acting head of the Department of Psychology and director of Student Personnel Services. Dr. Portenier served a three-year term as Executive Secretary of APA’s Division 2 (Teaching of Psychology) and edited the Newsletter (now TOPS) from 1952-1954. She served as President of Division 2 in 1957. She was the first person from the Rocky Mountain region to serve as National President of Psi Chi, a post she held from 1949 to 1952. She became involved with RMPA early on, presenting her first paper at the 1933 conference, a paper that examined factors other than intelligence that predicted school success. She served as RMPA Secretary from 1944-1948 and was elected President of RMPA in 1948-49. In 1963, she became the 3rd life member of RMPA.



MICHAEL WERTHEIMER

In 1983, Michael Wertheimer received the American Psychological Foundation Distinguished Teaching Award in recognition for his classroom teaching as well as his writings on the teaching of psychology. In 1990, he received the APA Distinguished Career Contributions to Education and Training in Psychology Award. Currently, Michael is Professor Emeritus at the University of Colorado - Boulder where he has served on the faculty since 1955. Among his many university recognitions, he received the Faculty Advising Award from the College of Arts and Sciences in 1987. Dr. Wertheimer served as President of Division 2 (Teaching of Psychology) in 1965. He was the Rocky Mountain regional coordinator of Psi Chi from 1973-1979 and in 1990-91 served as the Psi Chi National President. His involvement with RMPA began in the mid-1950s. At the 1957 RMPA meeting, he and Dr. Portenier both participated in the program. She was involved in a symposium on mental health in Western states, and Dr. Wertheimer presented a paper entitled *The influence of subjective time spent in practice on learning*. In 1981, Dr. Wertheimer was elected President of RMPA. He served as the RMPA Archivist from 1986-1993. He is the only person to twice receive the RMPA Distinguished Service Award, first in 1988 and again in 1994.



INVITED SPEAKERS

R. Eric Landrum, Preconference Keynote
2:00-2:55pm

Charles Honts, Past President Address, Kickoff Speaker
5:00-5:55pm

POSTER SESSION

6:00-7:30pm
Teaching of Psychology Posters

WORKSHOPS

3:00-4:55pm
APA Academic Career Workshop

4:00-4:55pm
Fall in or Fallout: Using the Bunker Exercise as a Teaching and Research Tool

TALKS

12:00-12:55pm
Teaching Take Out

12:00-1:55pm
Teaching of Psychology I

1:00-1:55pm
University Teaching and Advising
in a Changing World

Developing a Teaching Portfolio
to Document and Increase
Teaching Effectiveness

3:00-3:55pm
Developing the RMPA Faculty
Mentor Program

Yogi/ni in the Classroom:
Reaping the Academic Benefits
of Mindfulness

4:00-4:55pm
Overcoming Misconceptions:
The Effect of Perspective-Taking

SOCIAL NOTES ***

6:00-7:30pm, Aspen/Cedar
Kickoff Reception

PSI CHI TALKS

1:00-1:55pm
Beyond Survival: Making the
Most of Your Conference
Experience

2:00-2:55pm
Finding and Affording the Right
Graduate Program for You

3:00-3:55pm
Career Options and Strategies
for the Psychology Major

4:00-4:55pm
Effective Mentorship: Making
the Most of Your Undergraduate
Research Experience



	ASPEN/ CEDAR ROOM	RIVERFORK ROOM
12:00-12:55 PM	Teaching Take Out	
1:00-1:55 PM		University Teaching & Advising in a Changing World
2:00-2:55 PM	Preconference Keynote R. Eric Landrum	
3:00-3:55 PM		Developing the RMPA Faculty Mentor Program
4:00-4:55 PM		Overcoming Misconceptions: The Effect of Perspective-Taking
5:00-5:55 PM	Past President Address, Kickoff Speaker Charles Honts	
6:00-7:30 PM	Kickoff Reception & Teaching of Psychology Posters	

WHITE WATER ROOM	IVY ROOM	CLEARWATER ROOM
		Teaching of Psychology I
Beyond Survival: Making the Most of Your Conference Experience	Developing a Teaching Portfolio to Document and Increase Teaching Effectiveness	
Finding and Affording the Right Graduate Program for You		
Career Options and Strategies for the Psychology Major	Yogi/ni in the Classroom: Reaping the Academic Benefits of Mindfulness	APA Academic Career Workshop
Effective Mentorship: Making the Most of Your Undergraduate Research Experience	Workshop: Fall in or Fallout: Using the Bunker Exercise as a Teaching and Research Tool	



Dr. R. Eric Landrum

Boise State University

*Undergraduate Psychology Education,
The Importance of Skills, and a
Legacy at Risk*

The popularity of undergraduate psychology leads to challenges that the discipline may not be handling so well. Articulating what students should know and be able to do, followed by psychometrically meaningful assessment, comprise important steps to answering accountability concerns and building a sustainable future for undergraduate psychology education.

If we were to measure skills at the time of graduation, we could provide valuable information and confidence to our graduates, as well as ensure competencies to departments, institutions, employers, legislators, and citizens. Local skills assessment efforts exist, but nationally-coordinated efforts are warranted given the high stakes; fortunately, psychology educators are fully capable of leading the way.

Preconference
Keynote
Thursday, April 9
2:00-2:55pm
Aspen/Cedar
Room

Moderator:
William Douglas
Woody



Dr. Charles R. Honts

Boise State University

*Psychological Science and Actual Innocence:
Roles, Responsibilities and Policy Making*

With the advent of the use of DNA for forensic identification in the late 1980s it quickly became apparent that a number of people who were actually innocent had been wrongfully convicted for serious crimes. In 1992 the Innocence Project was formed to use DNA evidence to document and support those who had been wrongly convicted. Since that time the Innocent Project reports 316 documented DNA exonerations of the wrongly convicted in the United States. The National Registry of Exonerations, which includes exonerations that did not involve DNA, reports 1,374 cases of demonstrated false conviction. In examining the causes of wrongful conviction two areas, that are clearly in the domain of psychological science emerged, mistaken eyewitness identification and memory and false confessions. A third area, deceptive testimony by informants and other motivated parties is also an important contributor.

Over the last 20 years psychological science knowledge in these areas has grown substantially. While some progress has been made applying that knowledge to policy and criminal justice practice in some area, other areas reflect essentially unchanged practices. I will argue that professionals in psychological science have a responsibility, and even a duty, to not just generate knowledge, but to strive to see that knowledge reflected in practice and policy.

Past President
Address, Kickoff
Speaker
Thursday, April 9
5:00-5:55pm
Aspen/Cedar
Room

Moderator:
Steve Barney

TEACHING TAKE OUT
12:00-12:55PM, ASPEN/CEDAR ROOM
MODERATOR: WILLIAM DOUGLAS WOODY

So You Think You Can Draw! An Experiential Activity for Fine and Gross Motor Development

AARON S. RICHMOND

Metropolitan State University of Denver

Often times, students have a difficult time understanding fine and gross motor development. Thus, in this teaching-takeout I will demonstrate what it is like to go through fine and gross motor development.

Diagnostic Bingo

KRISTA D. BRIDGMON AND PATRICIA A. LEVY

Colorado State University-Pueblo

The presented teaching activity utilizes Bloom's Taxonomy (1956) allowing students will work in small groups to classify, discuss, and identify diagnostic features published in the DSM-5. Students will collaborate in a non-threatening interactive environment, while having the opportunity to defend, support, and evaluate the group's decision in Diagnostic BINGO.

Research Connecting Understanding to Belief

RICHARD L. MILLER & TYLER COLLETTE

Texas A&M University - Kingsville

Educational theory has neglected the distinction between understanding an idea and believing that idea. This is especially true of controversial issues. A research project for which collaborators are invited will first determine which controversial issues in psychology show a disconnect between understanding and belief. Second, the research will compare the effectiveness of several pedagogical techniques in addressing this issue.

Demonstrating Survey Bias

RICHARD L. MILLER

Texas A&M University - Kingsville

This session will provide attendees with a concise and powerful demonstration of survey bias to illustrate important principles of survey design and evaluation.

Privilege, Opportunity, and the Recycle Bin: Bringing a Demonstration of Privilege into University Classrooms

WILLIAM DOUGLAS WOODY

University of Northern Colorado

This presentation will provide participants with an expedient, economical, and poignant demonstration to safely and ethically illustrate the cognitive and emotion consequences of cultural privilege. I will then address ways to connect this demonstration to privilege in contemporary culture.

TEACHING OF PSYCHOLOGY I
12:00-1:55PM, CLEARWATER ROOM
MODERATOR: JAMES KOLE

The Undergraduate Internship Course: Perspectives from Faculty and Students

LINDA LOCKWOOD, RANDYL D. SMITH, PAMELA I.

ANSBURG, ANGELA FURNEY, RYAN COYLE, ALEXIS WARDEN, AND JENNIFER L. DELANGE

Metropolitan State University of Denver

Internships provide students with community-based experiences under the supervision of professionals in the field. The psychology internship program at Metropolitan State University of Denver supplements students' on-the-job experiences with a unique hybrid-design course. Students and faculty will share their experiences and provide information on the framework of this model program.

Mentoring Students Electronically: Theses and Dissertations in an Online Graduate Psychology Program

EDWARD CUMELLA

Kaplan University

Nearly 5,000 individuals earn psychology masters degrees annually through online universities. Many become clinically licensed; some teach or do research. Online schools attract underserved populations and have unique characteristics that impact graduate level research. The speaker offers experiences and data from four years of mentoring masters thesis research entirely online.

What do Students need to Succeed in the Workplace?

Exploratory Factor Analysis of the Workforce Readiness Scale and Differences between Perceptions of Students versus Alumni
EMILY CRADDOCK AND NORA DUNBAR

Northern Arizona University

We conducted an Exploratory Factor Analysis to examine the factor analytic structure of the Workforce Readiness Scale (Landrum, Hettich, & Wilner, 2010). We also examined differences between perceptions of workforce readiness in first-year students versus alumni. Implications for career planning courses and preparing students for the workforce will be discussed.

1:00-1:55PM, RIVERFORK ROOM

University Teaching and Advising in a Changing World
 ROXANNE SULLIVAN (1), PETER L. KRANZ (2), AND WILLIAM DOUGLAS WOODY (3)

(1) Bellevue University, (2) University of Texas-Pan American, (3) University of Northern Colorado

This symposium addresses challenges that arise from teaching in a changing cultural context. Our three presenters will address major teaching changes since the 1960s, important considerations related to teaching and supervising research online and in class, and recent changes that have increased the teaching risks in classrooms.

1:00-1:55PM, IVY ROOM

Developing a Teaching Portfolio to Document and Increase Teaching Effectiveness

GRANT C. CORSER AND LYNN H. WHITE

Southern Utah University

Teaching portfolios are increasingly becoming a required element of tenure, rank and promotion decisions in educational settings. Among their uses is to document or increase teaching effectiveness. Teaching portfolios can also be part of application materials for faculty positions. This workshop is designed to help faculty create/refine their teaching portfolio.

3:00-3:55PM, RIVERFORK ROOM

Developing the RMPA Faculty Mentor Program
 AARON S. RICHMOND (1), WILLIAM DOUGLAS WOODY (2), NORA D. DUNBAR (3), RICHARD MILLER (4), AND BRADY WIGGINS (5)

(1) Metropolitan State University of Denver, (2) University of Northern Colorado, (3) University of Northern Arizona, (4) Texas A & M University-Kingsville, (5) Brigham Young University, Idaho

In this session we will invite participants to discuss and develop the new RMPA Mentoring program for faculty. This includes potential goals and activities for the mentoring program.

3:00-3:55PM, IVY ROOM

Yogi/ni in the Classroom: Reaping the Academic Benefits of Mindfulness

LESLIE D. CRAMBLET ALVAREZ (1) AND BETHANY FLECK (2)

(1) Adams State University, (2) Metropolitan State University of Denver
 Eastern practices such as mindfulness have gained popularity in western science, psychology in particular. Benefits of mindfulness are well-documented in clinical and medical settings, and, emerging evidence supports the use of contemplative practices in the classroom. This interactive session explores ways of cultivating academic mindfulness for both students and faculty.

OVERCOMING MISCONCEPTIONS: THE EFFECT OF PERSPECTIVE-TAKING

4:00-4:55PM, RIVERFORK ROOM

MODERATOR: RICHARD MILLER

Assessing Ontological Misconceptions about Depression
 KAYLA SOELBERG, DENNY BESSIRE, ALEXANDRIA DANIELS, AND ERIC AMSEL

Weber State University

Introductory psychology students completed an assessment measuring their misconception of depression as a mental weakness rather than a mental illness. The scale was found to be reliable and valid, with the tendency to see depression as a mental illness related to a scientific understanding of mind and mental illness.

Overcoming Misconceptions About Depression: The Effect of Perspective-Taking

DENNY BESSIRE, KAYLA SOELBERG, ALEXANDRIA DANIELS, AND ERIC AMSEL

Weber State University

Introductory psychology students watched a video about depression and then completed a questionnaire assessing their belief that depression is a mental illness rather than mental weakness. Participants show stronger mental-illness beliefs only when instructed to think like the professor in the video, an effect that sustained a month later.

Overcoming Misconceptions about Depression: The Role of Persuasion

LUKE MCENTIRE, CELESTE MCCLANNAHAN, AND ERIC AMSEL

Weber State University

Introductory psychology students watched a video about depression and then completed a questionnaire assessing their beliefs about depression as a mental illness rather than a mental weakness. Females showed stronger short and long-term mental-illness beliefs when instructed to think about the arguments or like the professor in the video.

Overcoming Misconceptions about Physics: Generalizing the Effect of Perspective-Taking

ALEXANDRIA DANIELS, DENNY BESSIRE, KAYLA SOELBERG, ERIC AMSEL, AND ADAM JOHNSTON

Weber State University

Introductory physics students watched a video explaining electromagnetism and then completed a questionnaire assessing their beliefs about electromagnetism as violating or conforming to the law of the conservation of energy. Students held more consistent beliefs when instructed to think like the professor in the video than to focus on their beliefs.

TEACHING OF PSYCHOLOGY POSTERS

6:00-7:30PM, ASPEN/CEDAR ROOM

1 Self-Efficacy Interventions and Under-Performing Students: Improving Academic Outcomes

MARI MINER

Utah Valley University

Self-efficacy is the fundamental belief individuals have about their ability to perform a specific task (Bandura, 1986). Unfortunately, relatively little is known about the effectiveness of self-efficacy interventions in higher education. This study explored the relationship between academic self-efficacy interventions and academic performance and under-performing freshman at an open-enrollment university. Faculty Sponsor: Jessica Hill.

2 Classical Conditioning for the Classroom

ALLISON CROSS, KELLI GLENN, LAURA GRIGG, AND WINFORD A. GORDON

Western Carolina University

This study is testing a classical conditioning procedure that will demonstrate appetitive and aversive conditioning and discriminative conditioning. The procedure would be appropriate for use in a classroom without specialized equipment or disruptive stimuli. The procedure can be used with a large group or individuals. Faculty Sponsor: Winford Gordon.

3 Undergraduate Student Change in Colorblind Racial Attitudes: Impact of a Multicultural Psychology Course

CHRISTINA PATTERSON AND MELANIE DOMENECH-RODRIGUEZ

Utah State University

A total of 76 undergraduate students completed an upper division multicultural psychology class at a PWU over the course of two fall semester classes, 2013 and 2014. Results discuss change in colorblind racial ideology and the moderating effects of sociocultural empathy and multicultural experiences on colorblindness. Faculty Sponsor: Melanie Domenech-Rodriguez.

4 The Impact of Commitment on Reading Quiz Scores

RACHEL M. WONG

Southwestern College

The effects of commitment on reading quiz scores were examined. Forty-six students participated in the study, with twenty-one in the experimental group. To administer the commitment condition, students were either asked publicly or privately to commit to the readings. Students who did not commit scored higher on their reading quizzes. Faculty Sponsor: Carrie Lane.

5 Overall Quality and Characteristics of Peer Mentors and the Relation to First Year Student Perceptions of Resourcefulness, Connectedness, and Academic Skill In Higher Education

CHELSEA HONEA

University of Colorado Denver

Researchers have found a variety of outcomes of peer mentoring practices, including increases in first year students' perceptions of their own resourcefulness, connectedness, and academic skill. Relationships between peer mentor quality and characteristics with the aforementioned outcomes are examined. Findings may inform and guide peer mentoring practice in higher education. Faculty Sponsor: Mitchell Handelsman.

1:00-1:55PM, WHITE WATER ROOM

Beyond Survival: Making the Most of Your Conference Experience

CHRISLYN E. RANDELL (1), BETHANY FLECK (1), RONA J. MCCALL (2), AND SUSAN BECKER (3)

(1) Metropolitan State College of Denver, (2) Regis University, (3) Colorado Mesa University

Conference attendance can be a valuable student experience towards reaching future academic and career goals. This student-oriented session will help students focus on setting goals for their conference experience, prioritizing and organizing attendance at talks and presentations, convention protocol, and building relationships. Student attendees will receive conference survival kits.

2:00-2:55PM, WHITE WATER ROOM

Finding and Affording the Right Graduate Program for You

EDDY AMEEN

American Psychological Association of Graduate Students

There are many choices to make when looking at graduate programs in psychology. This workshop will discuss (a) masters and doctorates, (b) types of degrees and subfields, (c) ways to evaluate programs on objective and subjective data, and (d) how you can afford and repay graduate school. A time for Q&A will follow.

3:00-3:55PM, WHITE WATER ROOM

Career Options and Strategies for the Psychology Major

R.ERIC LANDRUM (1) AND SUSAN BECKER (2)

(1) Boise State University, (2) Colorado Mesa University

Explore your career options with your undergraduate degree. Presentation will include discussion about the job skills employers look for, how to test your interests and develop your skills, and career paths that reflect the interests and skills of psychology majors.

PSI CHI TALKS

4:00-4:55PM, WHITE WATER ROOM

Effective Mentorship: Making the Most of Your Undergraduate Research Experience

MARIA J. LAVOOY, Psi Chi Past-President, ROXANNE SULLIVAN (1), AND SUSAN BECKER (2)

(1) Bellevue University, (2) Colorado Mesa University

The working relationship between you and your research mentor has a large impact on your success in research, later employment and graduate school, and general wellbeing during your research experience. Topics to be discussed include your preparation for research, how to nurture the working relationship, and how to structure your time and effort.

THURSDAY WORKSHOPS

3:00-4:55PM, CLEARWATER ROOM

APA Academic Career Workshop

Presenters:

KRISTA BRIDGMON, Colorado State University, Pueblo

DANIEL HATCH, Southern Utah University

NICK MARSING, Snow College

CHRISLYN RANDELL, Metropolitan State University, Denver

JUDITH SUGAR, University of Nevada, Reno

Moderator: CRAIG BRYAN, University of Utah

What is the “right academic job,” and what does it take to land it?

This workshop is designed for aspiring academics who are currently graduate students or post docs. Five questions and others regarding the professoriate will be discussed. Expert panelists will share their insights with plenty of opportunity for discussion.

4:00-4:55PM, IVY ROOM

Fall in or Fallout: Using the Bunker Exercise as a Teaching and Research Tool

KAITLIN POTTER, STUART CLEMENTS, AND BRITTON MACE

Southern Utah University

Confronting prejudices and stereotypes is a difficult endeavor faced by educators in the social sciences. The fallout shelter exercise facilitates open classroom dialogue and discussion of individual prejudices and stereotypes. This session explores the use of this exercise as an impactful and beneficial teaching and research tool.



INVITED SPEAKERS

Tom Pyszczynski, Psi Chi Keynote Speaker
9:10-10:10am

Tom Pyszczynski, Conversation Hour
10:20-11:20am

Brian Nosek, Presidential Invited Address
3:20-4:20pm

Brian Nosek, Workshop
Improving Openness and Reproducibility
4:30-5:30pm
*Bring Laptop

David Myers, Diversity & Worth Lecture
4:30-5:30pm

PAPER SESSIONS

8:00-9:00am
Clinical/Counseling Psychology, Psychopathology
Industrial/Organizational, Consumer Psychology
Memory and Cognition I

9:10-10:10am
Psychology and Law

10:20-11:20am
Social Psychology I

1:00-2:00pm
Diversity (Homeless Populations)
Social Psychology II

2:10-3:10pm
Psychology of Women/Gender

3:20-4:20pm
Personality Psychology I, Measurement

POSTER SESSIONS

8:00-9:00am
Social Psychology I

10:20-11:20am
Learning, Memory and
Cognition, Educational and
School Psychology

PSI CHI TALKS

1:00-2:00pm
Making the Leap: How
Graduate School is Different
from Being an Undergraduate

4:00-5:30pm
Psi Chi Award Winners

SYMPOSIA

10:20-11:20am
Psychology Matters:
Helping Undergraduates
See Real-Life Connections to
Psychological Content

2:10-3:10pm
Ellis-Battig Memory Symposium

WORKSHOPS

2:10-3:10pm
Adolescent Brain Development
and Substance Use/Abuse

Designing Materials for a
Diverse World

1:00-2:00pm
Health Psychology, Sport Psychology

2:10-3:10pm
History/Philosophy/Religion
Personality Psychology

4:30-5:30pm
Developmental, Measurement
and Evaluation



SOCIAL NOTES ***

7:30-9:00am, White Water
Psi Chi Welcome Coffee

11:30am-1:00pm, Clearwater
Psi Chi Advisor's Luncheon
(Invitation-Only)

5:30-7:30pm, Ivy
Worth Publishers Reception
(Faculty Only)

6:00-7:00pm, White Water
Psi Chi Award Reception & Raffle

	ASPEN ROOM	CEDAR ROOM	EVERGREEN ROOM	WHITE WATER ROOM
8:00-9:00 AM			Social Psychology I	Psi Chi Welcome Coffee (7:30-9:00)
9:10-10:10 AM	Psi Chi Keynote Tom Pyszczynski			
10:20-11:20AM	Conversation Hour with Tom Pyszczynski	Psychology Matters: Helping Undergraduates See Real-Life Connections to Psychological Content	Learning, Memory and Cognition, Educational and School Psychology	
11:30 AM-1:00 PM	LUNCH BREAK			
1:00-2:00 PM			Health Psychology, Sport Psychology	Making the Leap: How Graduate School is Different from Being an Undergraduate
2:10-3:10 PM			History/Philosophy/Religion, Personality Psychology	Workshop: Designing Materials for a Diverse World
3:20-4:20 PM		Presidential Invited Address Brian Nosek		Psi Chi Award Winners Oral Paper Session (4:00-5:30)
4:30-5:30 PM	Diversity & Worth Lecture David Myers	Workshop with Brian Nosek *Bring Laptop	Developmental, Measurement and Evaluation	
5:30-7:00 PM				Psi Chi Award Reception & Raffle (6:00-7:00)

RIVERFORK ROOM	IVY ROOM	CLEARWATER ROOM	RAPIDS ROOM
Clinical/Counseling Psychology, Psychopathology	Industrial/Organizational, Consumer Psychology	Memory and Cognition I	
Psychology and Law			
Social Psychology I			
		Psi Chi Advisor's Luncheon (Invitation-Only)	
Diversity (Homeless Populations)	Social Psychology II		
Psychology of Women/Gender	Ellis-Battig Memory Symposium		Workshop: Adolescent Brain Development and Substance Use/Abuse
	Personality Psychology I, Measurement		
	Worth Publishers Reception (5:30-7:30) *Faculty Only		



Dr. Tom Pyszczynski

University of Colorado-Colorado Springs

Thirty Years of Terror Management Theory: From Genesis to Revelation

After nearly 30 years, Terror Management Theory continues to generate new research, conceptual extensions, applications to important social phenomena, and continuing discussion. From this perspective, human awareness of the inevitability of death plays an important role in diverse aspects of life, by fueling the human needs for meaning, self-esteem, and interpersonal connections. This talk will present our current assessment of the “state of the theory,” discuss the still growing body of research assessing it’s fundamental propositions, and consider the theory’s recent applications to diverse social phenomena, including political ideology, war, peace-making, and Posttraumatic Stress Disorder.

Psi Chi Keynote
Speaker
Friday, April 10
9:10-10:10am
Aspen Room

Moderator:
Susan Becker

Conversation
Hour with Dr. Tom
Pyszczynski
10:20-11:20am
Aspen Room

Moderator:
Krista Bridgmon
Elizabeth List



Dr. Brian Nosek

University of Virginia

Scientific Utopia: Crowdsourcing Research

The standard contributor model in science is vertically integrated. Resources are centralized to an individual or small team that conducts the entire research process: idea, design, collection, analysis, and report. This approach makes it easy to assign credit, but is inefficient in capitalizing on specialized expertise, produces a lot of small science, and is exclusive. A complementary model for science is horizontally distributed. Crowdsourcing modularizes and distributes the research process across many contributors. This approach leverages expertise, enables big science, and is inclusive. I will illustrate how adoption of crowdsourcing strategies can improve research efficiency in scientific research.

Dr. Nosek will also present a workshop entitled “Improving Openness and Reproducibility.”

Presidential Invited
Address
Friday, April 10
3:20-4:20pm
Cedar Room

Moderator:
Leslie Cramblet
Alvarez

Workshop with
Dr. Brian Nosek
4:30-5:30pm
Cedar Room

*Please bring
your laptop to the
workshop.

INVITED SPEAKERS



Dr. David Myers

Hope College

*A Quiet World: The Psychology of
Hearing and Hearing Loss*

Diversity & Worth
Lecture
Friday, April 10
4:30-5:30pm
Aspen Room

Moderator:
Anna Ropp

Drawing on personal experience and psychological science, David Myers will explore the biology and psychology of hearing and hearing loss. He will also explore user-friendly assistive technologies that reflect “the human factor,” and will describe efforts to double functionality of hearing aids and cochlear implants.

He is an internationally renowned scientist, author, and teacher whose research and writing have covered a wide range of topics in psychology.

Join us!

*Worth Publisher's
Reception*

Friday, April 10, 2015
5:30-7:30

FACULTY ONLY

A black and white photograph of a cityscape, likely Worth, Indiana, featuring several tall buildings and a large tree in the foreground. The logo for 'WORTH PUBLISHERS' is overlaid in the bottom right corner of the image.

CLINICAL/COUNSELING PSYCHOLOGY,
 PSYCHOPATHOLOGY
 8:00-9:00AM, RIVERFORK ROOM
 MODERATOR: NANCY KARLIN

Depression and Color Perception in College Students
 MICHAEL SCHROEDER AND LISA BADANES
 Metropolitan State University of Denver

This study examined how depression may change the way an individual perceives color in photographs. University students were given questionnaires assessing depression, cognitive vulnerabilities toward depression, and life satisfaction. After questionnaires were finished participants were asked to manipulate color saturation on twenty different photographs. Faculty Sponsor: Lisa Badanes.

Client Perceptions of the Use of Telecommunication
 Technology to Facilitate Psychotherapy
 BENJAMIN SALAZAR AND DEVIN PETERSEN
 Brigham Young University

Client perceptions and attitudes toward telemental health interventions were examined. 221 active clients at a university counseling center were given the Attitudes Toward Teletherapy scale, which assessed client interest, perceived advantages and concerns related to the use of technology to facilitate psychotherapy. Implications for clinical practice are discussed.

Clarifying the Relation of Combat and Suicide Risk Among
 Military Personnel and Veterans
 CRAIG J. BRYAN

National Center for Veterans Studies & University of Utah
 We conducted a narrative review and meta-analysis of 21 published studies to integrate findings regarding the relationship of deployment-related predictors with suicide-related outcomes. Across all predictors and outcomes, the relation of deployment-related predictors and suicide-related outcomes was small but statistically significant ($r=0.08$). Among studies focused on killing and death exposure, there was a larger relationship ($r=0.13$).

The Effects of Canine Obedience Training on PTSD Symptoms
 and Depression
 KENT D. HINKSON JR. AND SAVANNAH BUSHMAN
 Utah Valley University

The effects of basic canine training on symptoms of depression and posttraumatic stress disorder were examined among 34 veterans. Two instruments (PCL-M & ICP) were administered both before and after a twelve-week course of training with dog and veteran. Results showed a strong effect on various scores on both instruments. Faculty Sponsor: Cameron John.

INDUSTRIAL/ORGANIZATIONAL, CONSUMER
 PSYCHOLOGY
 8:00-9:00AM, IVY ROOM
 MODERATOR: COURTNEY ROCHELEAU

Wrecking Work with Rudeness: Behavioral Outcomes of
 Experienced Incivility in the Workplace
 ARYANNA WIGGINS

Metropolitan State University of Denver
 This literature review explores the evidence that has been found on individuals who experience incivility (ambiguous intent to harm) in the workplace and their associated behavioral outcomes. Further descriptions will include the measures utilized, methodologies to findings, and noted cases of samples identified. Directions for future research are also discussed. Faculty Sponsor: Courtney Rocheleau.

Productive Personalities in the Workplace: An Exploratory Study
 on Employer Personality Effects on Employees
 TY PALMER
 Utah Valley University

The effects of a supervisor's personality on employee productivity were examined. Researchers have constructed two instruments based on Big Five Personality Theory. One measured the employee's view of their

supervisor's personality. The other measured the employee's productivity. The two were compared to assess for significant correlations. Faculty Sponsor: Cameron John.

Influences on Consumer Behavior when Purchasing Hedonic Goods MALISA BROOKS AND RUSSELL WARNE

Utah Valley University

An investigation of factors influencing consumer behavior in response to information about luxury goods. In a true experiment, we observed 318 participants' reactions to versions of advertisements that emphasized authority or authenticity (through social networking). Results indicated that person variables (e.g., gender) were more important than authority or authenticity.

Non-expert Interpretations of Hurricane Forecast Uncertainty Visualizations

IAN T. RUGINSKI (1), ALEXANDER P. BOONE (2), LACE M. PADILLA (1), MARY HEGARTY (2), WILLIAM B. THOMPSON (1), DONALD H. HOUSE (3), AND SARAH H. CREEM-REGEHR (1) (1) University of Utah, (2) University of California Santa Barbara, (3) University of Clemson

Uncertainty is inherent in hurricane forecasts visualizations. Our goal was to test whether different graphical displays (glyphs) of a hurricane forecast containing uncertainty would influence a decision about how much damage an oil rig would receive. Faculty Sponsor: Sarah H. Creem-Regehr.

MEMORY AND COGNITION I
8:00-9:00AM, CLEARWATER ROOM
MODERATOR: JAMES KOLE

Caffeine Does Not Impact Phonological Priming Effects on Word Retrieval

SARA ANNE GORING

University of Colorado Colorado Springs

The effects of caffeine ingestion and phonological priming on word retrieval were examined. Participants, assigned to consume caffeinated or regular water, were given phonologically-related or unrelated primes prior to a definition-naming task. Results reveal a numerical pattern consistent with existing theory but inconsistent with some previous research. Faculty Sponsor: Lori James.

What Gives Rise to a Sense of Novelty? An Exploration of Novelty Within Recognition Memory

SHELLY R. STALEY

Colorado State University Fort Collins

Many memory models outline novelty as the opposite of familiarity. However, experiences such as *deja vu* suggest that the two may coincide. Feature-match between a present event and remembered events can influence familiarity strength. Could it inversely affect novelty? Through two experiments, we investigated determinants of the sense of novelty. Faculty Sponsor: Anne Cleary.

Does Concurrent Stress Affect Word Retrieval Across the Lifespan? CHRISTOPHER SCHMANK

University of Colorado Colorado Springs

We conducted a study on how stress impacts tip-of-the-tongue (TOT) states using a lifespan approach. Stress was manipulated in laboratory settings for all participants. Stress and age predicted correct responding, whereas stress was only predictive of TOT states. The findings appear to demonstrate that stress may better predict TOTs than age. Faculty Sponsor: Lori James.

Effects of Stress on Speech Production in Older and Younger Adults MARISSA METZ

University of Colorado Colorado Springs

The effects of stress on speech errors, pauses, and cognitive complexity were examined. Older and younger adults performed speeches during the Trier Social Stress task, and these speeches were transcribed and analyzed. Stress tended to be detrimental to younger adults' speech and beneficial to older adults' speech. Faculty Sponsor: Lori James.

PSYCHOLOGY AND LAW

9:10-10:10AM, RIVERFORK ROOM

MODERATOR: NANCY KARLIN

Intrinsic Religious Motivation, Preference for Consistency, and Pro-Acquittal Bias: The Surprising Converse of Authoritarian Intolerance
EVAN ROBERTSON AND NAHANNI FREEMAN

Colorado Christian University

In an investigation of mock juror attitudes, higher intrinsic religious motivation and higher preference for consistency were associated with a greater tendency to be acquittal-prone when subjects evaluated hypothetical kidnapping and medical malpractice vignettes.

Corporate Interviews: Civil Jurors' Perceptions, Decisions, and Damage Awards

WILLIAM DOUGLAS WOODY, CZARINA GROGAN,
THEODORE J. ALBO, AND MITCHELL D. STAUT

University of Northern Colorado

We studied civil jurors' perceptions and decisions about liability and damage awards in cases involving former employees who take civil legal action against former employers about interview tactics used by employers to extract theft confessions from employees. The use of deception during the interview affected participants' perceptions and trial decisions.

Does Emotion Factor Into Opinions on the Death Penalty?

TYLER MCDONALD

Utah Valley University

The present research was conducted in order to examine whether public opinion on the issue of the death penalty is emotionally based. Results provide evidence that a majority of the public remains ill-informed about capital punishment and may not easily change in opinion, even if informed otherwise. Faculty Sponsor: Cameron John.

SOCIAL PSYCHOLOGY I

10:20-11:20AM, RIVERFORK ROOM

MODERATOR: CHERYL SANDERS

Cyberbullying in Young Adulthood: Perceived Definitions, Prevalence, and Bystander Responsibility
KASSANDRA M. GAHAGAN, J. MITCHELL VATERLAUS, AND
LIBBY R. FROST

Montana State University

This exploratory study reports young adults' (18-25 years old; n = 92) definitions, perceived prevalence, response to witnessed, and perceived bystander responsibility of cyberbullying on social media. Participants stated that bystanders, or those who witness cyberbullying, have a responsibility to respond; yet most did not respond themselves.

Influence of Emoticons on Perceptions of the Sender and Stereotyping in Electronic Communication

ASHLEE THURSTON, COLBY CEVERING, MEGAN JUMP, AND
LYNN H. WHITE

Southern Utah University

Participants read a standardized email written by a male or female student, which contained either plain font, bold/italicized font, or emoticons. The results suggest that emoticons used in emails influences the reader's perception of the sender's mood, attitude, and likeability. Perceived sexual orientation of the sender was not affected.

Effects of Linguistic Forms and Group Labels on Anti-gay Prejudice

RHIANNA J. SCHELL, ROBERT T. SCHATZ, AND KATRINE
WILLOW

Metropolitan State University of Denver

The research examined the effects of linguistic forms and social category labels on anti-gay prejudice. Results indicated significantly higher prejudice for use of the category label homosexual relative to the label gay, and non-significantly higher prejudice for use of nouns (e.g., gays) relative to adjectives (e.g., gay people).

Argumentative versus Concurrence-Seeking Groups: Belief Perseverance, Personal Control, and Self-Efficacy
NAHANNI FREEMAN, LARA PLUM, KAYLEE BARNETT, AND KATELYNN RIDGE

Colorado Christian University

Subjects exposed to an argumentative confederate during focus group debates about controversial topics did not show differences in belief perseverance when compared to participants who encountered a concurrence-seeking, cordial confederate. Belief perseverance was greater with higher self-efficacy, argumentativeness, belief in personal control, and conservatism. Beliefs about capital punishment shifted less.

DIVERSITY (HOMELESS POPULATIONS)

1:00-2:00PM, RIVERFORK ROOM

MODERATOR: ANNA ROPP

Research to Better Understand Homeless Trends in Youth
THERESSA ZOOK, LINDSEY SITZ, AND TIMOTHY MANN

Metropolitan State University of Denver

This study examines current trends of homeless in Denver, Colorado. Homelessness is a problem in the United States and around the world. This study seeks to understand educational and health outcomes of youth (17-25) that are homeless compared to the educational and health outcomes to those who are over 26. Faculty Sponsor: Bethany Fleck Dillen.

Colorado Marijuana Legislation: An Empirical Review of Amendment 64's Impact on Metropolitan Denver's Homeless Population

COREY A. ENGLE, HEATHER M. HAMILTON, MELANIE TRENARY, LAURA BLACKMOND, MARIA JOSE YTTERBERG, BIANCA GONZALEZ, CHRISTINE RUDZINSKAS, AND RANDYL SMITH

Metropolitan State University of Denver

This retrospective study explored whether legalization of recreational use marijuana (RMJ) in Colorado has drawn more homeless people to the Denver area since January 1, 2014 when sale and private consumption

of RMJ became legal. Data obtained from multiples years of Project Homeless Connect Denver were analyzed.

In College and Homeless: A Preliminary Study of Homelessness among University Students

RANDYL D. SMITH

Metropolitan State University of Denver

This study aimed to discover the prevalence of student homelessness on one large urban campus. In response to a campus-wide survey, 187 participants identified themselves as homeless and provided information about the factors that contributed to their homelessness as well as the attendant challenges.

Comparing Homeless Veterans' Self-reported and Providers' Perceptions of Need

KELSY NEWTON, KAT ALTAIR, AND LISA CHRISTIANSEN

Pacific University

Our study compared the perceptions of homeless veterans regarding their mental health issues, level of social support, and perceived barriers to accessing mental health services with the perceptions of the case workers who work with veterans. Results were significant and indicated there were areas that providers and homeless veterans diverged. Faculty Sponsor: Lisa Christiansen.

SOCIAL PSYCHOLOGY II

1:00-2:00PM, IVY ROOM

MODERATOR: CHRISLYN RANDELL

The Effects of Physical Attractiveness on a Classroom Learning Task
R. SHANE WESTFALL, MURRAY MILLAR, AND MANDY WALSH
University of Nevada, Las Vegas

The effects of instructor physical attractiveness on a learning task were examined. One hundred and thirty-one participants completed a quiz following a lecture with an attractiveness manipulation. As predicted, there was a statistically significant difference in test scores when participants believed their instructor to be physically attractive.

So..Umm...Do They Influence our Speech?

LANE DEINES AND THERESA WADKINS

University of Nebraska at Kearney

We hypothesized exposure to ums would have a contagious effect. A between groups design was used where participants memorized a speech, viewed a videotaped speech with or without ums, and delivered the memorized speech. The number of ums was counted. Participants in the experimental group uttered significantly more ums than those in the control group.

Perceptions of Desirability and Attractiveness for Online Dating Profiles with Non-Monogamous Relationship Cues

MICHAEL C. CLARK, STEVEN MCKINLEY, AND RITA

SCHENKELBERG

Colorado Mesa University

The attractiveness and desirability of a relationship of online dating profiles were analyzed based on the presence or absence of non-monogamous relationship cues. Six hundred students completed the experiment with 200 in each condition group. Data suggests sex differences in attraction in line with evolutionary theory on mate selection. Faculty Sponsor: Susan Becker.

Can Memory of Others be Overshadowed by One Bad Experience?

GEOFFREY STREETER

University of Nebraska at Kearney

Kahneman has suggested that more recent negative events within a personal experience can color the overall memory. We tested this hypothesis but in regard to assessing the performance of an athlete, whose performance included an error placed at different locations in a sequence. Only a primacy effect was found. Faculty Sponsor: William Wozniak.

PSYCHOLOGY OF WOMEN/GENDER

2:10-3:10PM, RIVERFORK ROOM

MODERATOR: KATHERINE HILL

The Ubiquitous Role of Sleep on Women's Health: Complications and Challenges

CODIEANN DEHAAS, PENNIE S. SEIBERT, DANIELLE NEBEKER, CHRISTIAN G. ZIMMERMAN, AND FRED GRIMSLEY

Saint Alphonsus Health System and Boise State University

Sleep disorders affect one's well-being and increase the likelihood of psychological disorders (PDs); sex and age differences further complicate diagnosis/prognosis of SDs. Analysis of 1043 participants evaluating sex differences, and age differences in women specifically, revealed women reporting numerous physical and psychological differences compared to men and across the lifespan.

Monogamy: Latter Day Saint Women's Perspectives

BROOKE BRADFORD

Utah Valley University

What does it mean to be faithful to a spouse? This study examines monogamy from the unique cultural perspective of women who are members of The Church of Jesus Christ of Latter Day Saints or Mormon. The understanding that these women have of sexual relationships is then compared with the views of other populations. Faculty Sponsor: Cameron John.

Gender Socialization Predicts Sex Differences in Socially Desirable Responding and Shame-Coping

JEFF ELISON, STEPHANIE HILWIG, BENJAMIN WADDELL, AND JUSTINE BRYDGES

Adams State University

The Hyper-Gender Scale, Balanced Inventory of Desirable Responding, and Compass of Shame Scale were administered to 175 undergraduates. Participants who more highly endorsed traditional gender roles reported more self-deceiving enhancement and less impression management, which in turn predicted gender differences in Withdrawal, Attack Self, and Attack Other shame-coping.

Sexual Assault Experiences: Exploring Conservative Socialization Experiences as an Important Contextual Factor
ANALISE BARKER

Utah State University

Literature addressing sexual assault in the U.S. assesses risk and interpretation of assault. There are also studies about the roles of religion/faith in healing from sexual assault. This study evaluates gendered socialization and sexual behavior of college students, and evaluates how assault experiences are influenced by cultural and religious contexts.

Faculty Sponsor: Renee Galliher.

PERSONALITY PSYCHOLOGY I, MEASUREMENT

3:20-4:20PM, IVY ROOM

MODERATOR: CHRISLYN RANDELL

Shame-Coping and the Big Five Personality Traits

JEFF ELISON

Adams State University

The NEO-FFI and Compass of Shame Scale were administered to 154 undergraduates. Some previous results failed to replicate; however, the most important hypotheses for each shame-coping style were supported by correlations with at least two personality traits ($r_s: .17-.63$). The largest effects were between Neuroticism and Attack Self and Withdrawal.

Right-Wing Authoritarianism, Social Dominance Orientation, and Anti-Transgender Prejudice

ANDREA WUCHERPFENNIG AND ROBERT SCHATZ

Metropolitan State University of Denver

Correlation and regression analysis were used to examine differences in two personality factors as they relate to anti-transgender attitudes, Right-Wing Authoritarianism (RWA) and Social Dominance Orientation (SDO). Results indicated that anti-transgender prejudice was more strongly associated with RWA than with SDO.

Constraining Beliefs about Romantic Relationships, Causal Attributions, and Religiosity

NAHANNI FREEMAN AND AMALEE BOWEN

Colorado Christian University

Participants ($n = 144$) completed a battery of attributional assessment inventories. Participants supporting the ludic style of love were more likely to endorse the constraining attitudes associated with belief in a soul-mate. Belief in personal control related inversely with belief in God as a causal agent.

Self vs. Other Administration of a Noxious Stimulus: The Moderating Effect of Locus of Control on Anticipatory and Post-stimulus Pain

LYNN H. WHITE AND ALEXIS B. NELSON

Southern Utah University

We assessed anticipatory and post-prick finger pain, skin conductance, anxiety, and perceived unpleasantness in participants who pricked their own finger and in participants where the experimenter performed the procedure. The influence of participants' locus of control was statistically controlled to determine its role as a potential moderator.

SOCIAL PSYCHOLOGY I 8:00-9:00AM, EVERGREEN ROOM

1 The Effects of Female Mate Value on the Desirability of Male Social Status

MANDY WALSH, R. SHANE WESTFALL, AND MURRAY MILLAR
University of Nevada, Las Vegas

The effects of female mate value on the desirability of male social status were examined. Sixty females completed a mate value inventory and rated their desirability of men with high and low status occupations. High mate value females rated high status occupations more positively than low status occupations.

2 "The Measure Ye Mete": Social Identity Priming and Moral Judgment

JORDAN MOON, CODY BROADBENT, EMILY ROBINSON, AND ROBERT WRIGHT
Brigham Young University - Idaho

The effects of social and moral identity on moral judgment were studied. Using both a random sample and a convenience sample, we found that participants primed with a moral fable were more judgmental than those in the control and social identity groups. Faculty Sponsor: Robert Wright.

3 Violent Video Games and Beliefs about Aggression

JACOB SANDERS (1), ZACH SCHULTZ (1), LUKE BOTE (1), AND CHERYL SANDERS (2)

(1) Faith Christian High School, (2) Metropolitan State University of Denver
This study examined the relationship between violent video game playing and beliefs about aggression. Sixty-two high school students completed the Beliefs about Aggression questionnaire and a video game assessment. Results revealed significant differences in opinions about aggression between video gamers and non-gamers. In addition, a significant gender difference was found.

4 Conforming to Memory Distortion

COURTNEY ZEFF, ANNA SEWELL, AND PATRICK MALLORY
The College of Idaho

What is the relationship between conformity and false memory adoption? We expanded on a standard false memory manipulation with three

different measures of conformity. In the partly online and partly lab-based study we gave subjects emotional false memories and found a relationship between deception and trait conformity. Faculty Sponsor: Cara Laney.

5 Reflective Journaling: Building Middle School Students' Self-Esteem and Self-Efficacy

KATELYN HASCHKE
University of Nebraska at Kearney

Previous research supports that reflective journaling positively impacts synthesis of thought; used as a support strategy it improves mood and functioning of depressed and anxious individuals (Pajares, 2003; Nicholas, 2006). This study looked at the effect reflective journaling had on middle school students' self-esteem, self-efficacy, and stress levels. Faculty Sponsor: Krista Fritson.

6 Individual and Situational Differences in Victim Blame

BETHANY VENN
Southwestern College

Individual and situational characteristics were measured to assess the level of victim blame. Fifty-seven individuals were administered personality, humility and attribution of blame measures and were randomly assigned into mortality salience and victim characteristic manipulations. There was a main effect of personality and gender on level of victim blame. Faculty Sponsor: Carrie Lane.

7 Practicing Executive Inhibition of a Stigmatized Social Identity Improves Performance on a Stereotype-Relevant Task

AARON A. SHILLING (1), RUTH H. WARNER (2), CHRISTINA M. BROWN (3), AND AISHIA R. O'LEARY (1)
(1) The College of Idaho, (2) Saint Louis University, (3) Arcadia University

Previous research has found that inhibiting a stigmatized social identity impairs performance on a stereotype-relevant task, whereas other research has found performance benefits of such inhibition. We predicted and found evidence that practicing, or automating, female identity inhibition may improve subsequent math performance. Implications for theory and interventions are discussed.

8 The Effects of Liberal and Conservative-Oriented Political Messages on Ideology and Attitudes Towards Gay Marriage

MATTHEW CHRISTIANSEN

Southern Utah University

The effects of liberal and conservative-oriented political messages on ideology and attitudes towards gay marriage were measured. Conservative and liberal participants were randomly assigned to read a liberal or conservative message. Shifts in ideology and attitudes towards gay marriage were assessed in a pre-post design. Faculty Sponsor: Garrett Strosser.

9 “Commons” Cooperation or Greed in the Classroom

TERI RUST AND BENJAMIN SELOSKE

Lewis-Clark State College

A classroom adaptation of the “tragedy of the commons” was presented to 27 classes. A significant percentage of classes (74%) followed the “rational” recommendation of self-interest resulting in tragedy rather than common benefits. However 67% cooperated on a second opportunity. Gender and course grades were examined as predictive factors.

10 The Effects of Sleep Deprivation on Susceptibility to Conformity

ANASTASIA M. BACCA, STEVEN J. TERRY, KELSIE S. HOWELL, AND KELLY B. MCCARTY

Metropolitan State University of Denver

The relationship between self-reported sleep deprivation and conformity was examined (assessed via change in ratings on a picture-ratings task following exposure to conformity statements). Conformity did not significantly differ between the high- versus low-sleep deprivation groups. A refined follow-up study will also be reported. Faculty Sponsors: Lisa Badanes and Kristen Lyons.

11 Effects of Power Priming and Socioeconomic Status on Attraction and Dating Ratings

L. ANDRE GONZALEZ

Regis University

Female participants primed to think about power or not viewed photos of high and low socioeconomic status men and rated their attractiveness. There was a significant interaction: power primed women were more attracted to low than high SES, but unprimed women rated low and high SES equally attractive. Faculty Sponsor: Amanda Miller.

12 Personality Determinants of Financial Literacy and Intention Across Ethnicities and Sexes

JOANNE R. ULLMAN AND N. CLAYTON SILVER

University of Nevada, Las Vegas

Economic security requires financial knowledge and the intention to practice healthy spending and savings activities. Using data from 337 participants, personality traits that influenced financial literacy levels were distinguished from those of financial intention. Strength of these personality traits on knowledge and intention appeared to differ across sexes and ethnicities.

13 Effects of Violent Video Games on Moral Decision Making

RICHARD GIBSON, ALLEN DICKINSON, MATTHEW WHEELWRIGHT, JACOB WEAVER, AND SHANNON MCGILLIVRAY

Weber State University

The effects of violent and non-violent video games on moral decisions were examined. Sixty-four participants played a video game, then answered several moral dilemmas, and indicated their willingness to cause harm to another for a greater good. Only males who played a violent game were more willing to cause harm. Faculty Sponsor: Shannon McGillivray.

14 Gadget Obesity in Rural Areas

NICK MARSING, KRISTAL LANDA-FERRON, AND REBECCA BAGGETT

Snow College

Gadget Obesity, or the the accumulation and non-disposal of electronic devices, is a term recently coined by the company uSell. Although likely biased, the research does raise interesting questions about what Americans do with their devices. The current study examines specifically how rural populations view and treat outdated devices.

15 Self-Enhancement Bias in Self-Partner Personality Comparisons

AMY FRERS AND AMANI EL-ALAYLI

Eastern Washington University

We tested whether people attribute more favorable traits to themselves than to their partners when participating in self-partner comparisons. As predicted, participants viewed traits possessed more by oneself as more favorable than traits possessed more by one’s partner. This bias was associated with higher self-esteem and lower relationship satisfaction.

LEARNING, MEMORY AND COGNITION, EDUCATIONAL AND SCHOOL PSYCHOLOGY
10:20-11:20AM, EVERGREEN ROOM

1 Instructors' Humor and Its Effect on Students' Emotions
MOSHE MACHLEV AND NANCY KARLIN
University of Northern Colorado

Research about the effect of instructor's use of different types of humor on student's emotions is limited. The present study examined this issue. It was found that humor that is relevant, spontaneous, and appropriate is positively associated with student's emotions, while inappropriate humor is negatively associated with student's emotions. Faculty Sponsor: Nancy Karlin.

2 Instructor's Use of Different Types of Humor and Students' Perceived Relatedness Toward their Instructors
MOSHE MACHLEV AND NANCY KARLIN
University of Northern Colorado

Previous research has shown that student's (perceived) relatedness toward an instructor is connected to instructor use of humor. The present study examined this issue by considering different types of humor. Results suggest that spontaneous and appropriate humor are positively associated with relatedness, while offensive humor is associated negatively with relatedness. Faculty Sponsor: Nancy Karlin.

3 Mindfulness Meditation and Test Performance
ISAAC PFLEGER, JACOB PFLEGER, AND MATTHEW WHOOLERY
Brigham Young University - Idaho

This study examines the effects of mindfulness meditation on test performance in a real testing situation. The exam scores of two Psychology classes at Brigham Young University-Idaho were compared after participating in either mindfulness meditation or a lecture on test anxiety. Additionally, test anxiety was measured and compared between classes.

4 The Benefits of Googling It?
TYSON BRYANT, JOSHUA J. HUNT, ALICIA M. LEE, DAVID S. SLEIGHT, BLAKE TUBBS, AND SHANNON MCGILLIVRAY
Weber State University

The current study examined the effect of actively looking up information using Google versus passively being exposed to information on later

memory performance. Prior studies have focused on detrimental effects of Google reliance on memory, but the current study examined the potential benefits of Googling it. Faculty Sponsor: Shannon McGillivray.

5 The Effects of Singing and Rhyming on Short-term Memory
KALINA LARSON
Regis University

We examined the effects of rhyming versus non-rhyming words, and singing versus reading the words on short-term memory. Rhyming words were recalled more frequently than non-rhyming words. There was one significant interaction: rhyming words in the reading condition and non-rhyming words in the singing condition were best serially recalled. Faculty Sponsor: Amanda Miller.

6 Validating the Reversible Figure Test with the Abbreviated Sustained Attention
KELLI GLENN, LAURA GRIGG, ALLISON CROSS, CASEY HESTER, CARA MEYER, AND WINFORD A. GORDON
Western Carolina University

This study compared scores on the Reversible Figure Test (RFT) with and abbreviated version of the Sustained Attention Response Task (ASART). Participants completed four tests with the RFT, ASART or a combination of the two. This study is part of the effort to validate the RFT. Faculty Sponsor: Winford Gordon.

7 Earliest Childhood Memories
CLARESSA MOORE AND JENNIFER TORRES
College of Idaho

Researchers have attempted to manipulate the age of subjects' earliest childhood memory by using scales or confederates. We manipulated the age of recall by using a false statistic, given to half of the subjects. This group reported an age about half a year lower than the group who received nothing. Faculty Sponsor: Cara Laney.

8 The Impact of Feedback on Predictions of Future Memory Performance
DANIELLE FOSTER, WYATT KITTLSTVED, AND DANIELLE SITZMAN
Eastern Washington University

Feedback is crucial for correcting errors in memory; however, previous research suggests people do not fully appreciate the benefits of feedback.

The current experiments seek to further understand this effect and explore methods that may enhance a participant's ability to predict how feedback will impact error correction on future tests.

9 The Effects of Expertise on Visual Memory
 HOLLY N. ROBERTS AND CYNTHIA A. ERICKSON
 Metropolitan State University of Denver

This study seeks to examine the effects of expertise on visual memory. This effect is being studied by showing experts and non-experts visual images, some related to a particular expertise, others not related. Results thus far show that non-expert participants have significantly better memory for non-expert images than expert images. Faculty Sponsor: Cynthia Erickson.

10 Smartphone Use, Test Performance, and Anxiety
 HENDRIK OMBACH, J'LENE REA, AND SHANNON MCGILLIVRAY
 Weber State University

Smartphones have become more ubiquitous and cases of smartphone addiction have risen. This study measures smartphone addiction, test performance, and anxiety levels of participants who are either allowed or not allowed to use their phones during a test to understand the negative consequences of smartphone addiction on memory performance. Faculty Sponsor: Shannon McGillivray.

11 Dyadic Family Functioning Mediates the Association between School Problems and Depressive Symptoms among Habitually Truant Youth
 CHRISTOPHER R. DECOU, STEPHANIE C. BABBITT, ELIZABETH A. CRAUN, STEPHANIE P. KAPLAN, AND COURTNEY M. HAIGHT
 Idaho State University

The mediating influence of dyadic family functioning upon the association between school problems and depression was examined in a sample of 41 habitually truant youth. Students' perceptions of dyadic control and values and norms fully mediated the association between school problems and symptoms of depression. Faculty Sponsor: Courtney M. Haight.

12 A Glimpse into the Mind of a Special Education Teacher: A Qualitative Look at the Perspective of Teaching Effectiveness in Public School Special Education

MEAGAN DEUSER
 Northwest Nazarene University

The perception of teaching children with special needs in public schools was examined. Twenty school officials and teachers were surveyed regarding methodology, support and effectiveness of teaching students with special needs. Public school employees were found to have a perceived lack of support and training to be effective in teaching. Faculty Sponsor: Elizabeth List.

13 Significance of English Proficiency in the Employment Sector: Connection to Soft Skills, Social Integration, and Success in the Workplace
 AMANDA MCKEEVER, ALISON ALMONTE, MICHELLE BUTLER, AND ANDREW KATAYAMA
 United States Air Force Academy

The effects on occupational success with English proficiency were examined. Ten students completed an employability program, were surveyed, and student surveys were compared to standardized English literacy data provided by the school. English proficiency plays an important role in the success of individuals who are deaf in the job market. Faculty Sponsor: Michelle Butler.

14 How Different Types and Sources of Feedback Affect Student Attitudes Toward the Reviewer and the Feedback
 MICHELLE KLEIN AND JOAN BIHUN
 University of Colorado Denver

The factors that influence whether or not students use feedback were investigated. Participants were asked to imagine a scenario and answered questions to determine their attitudes toward the reviewer and the feedback. The questions focused on motivation and mindset, helpfulness of feedback, and likelihood of using the feedback. Faculty Sponsor: Joan Bihun.

15 Correlates of Educational Performance in Polygamous Families
 TODD C. BAIRD AND JACLYN KNAPP
 Weber State University

The purpose of this study is to improve our understanding of the possible influence of polygamous family structure on academic achievement in children. It is hypothesized that the same predictors of academic achievement in other family structures will also apply to the academic functioning of children from polygamous families.

HEALTH PSYCHOLOGY, SPORTS PSYCHOLOGY
1:00-2:00PM, EVERGREEN ROOM

1 A Portrait of Five Undergraduate Students Who Serve as Caregivers While Taking University Courses
EMILY OWENS, CARLEY ULIBARRI, BLAKE D. KARLIN, AND NANCY J. KARLIN

University of Northern Colorado

The current study sought to identify characteristics specific to adults who became caregivers while taking classes from an institution of higher education. These caregivers reported high levels of self-efficacy with regard to the care process, minimal depression, low to moderate levels of burden, and high resiliency. Faculty Sponsor: Nancy Karlin.

2 The Complex Role of Sleep on Age Groups: Pediatrics, Adults, and Geriatrics

DANIELLE NEBEKER, PENNIE S. SEIBERT, CODIEANN DEHAAS, CHRISTIAN G. ZIMMERMAN, AND FRED GRIMSLEY

Saint Alphonsus Health System, Boise State University

Sleep disorders (SDs) are prevalent across ages: the clinical signs, symptoms, and their manifestations vary according to age. SDs have myriad of medical issues increasing the likelihood of being misdiagnosed, undiagnosed, and ignored. Our research examines the occurrences of SDs at all ages to characterize age specific patterns.

3 Spinal Injury Recovery: Implementation of Patient Empowerment Through Applications from Psychological Science

CHARICE HUBBARD, SHARLYNN THOMPSON, PENNIE S. SEIBERT, CODIEANN DEHAAS, DANIELLE NEBEKER, AND CHRISTIAN G. ZIMMERMAN

Saint Alphonsus Health System, Boise State University

We present a longitudinal case study observing the treatment and recovery of a college football player who sustained a Jefferson fracture to the C1-2 vertebrae. Utilizing a patient empowerment approach, the individual took an active role in recovery and ultimately exceeded pre-injury athletic prowess.

4 The Effect of Dietary Fat Intake on Mood and Global Well-being
NATHAN R. JACQUEZ AND LYNN H. WHITE

Southern Utah University

Does replacing dietary saturated fat with monounsaturated or polyunsaturated fat affect mood? Daily assessment of mood, physical activity, well-being, and stress were assessed following a 3 week intervention in participants placed on an olive oil or corn oil replacement regime, relative to a saturated fat control.

5 Building Self-Confidence

JESSICA D. MOORE

Boise State University

Once a month, self-love activities were presented to a group of sorority women. Each activity focused on a different aspect of self-love and confidence. Continued exposure and reminders of how to love one's self resulted in lower levels of body dissatisfaction and higher self-confidence in these women. Faculty Sponsor: Mary Pritchard.

6 The Relationship Between Ethnic Identity and Racial-Ethnic Microaggressions Among University Students of Color

CHAZLYN A. MILLER, ALYSSA M. SFERRAZZA, AND MONICA C. SKEWES

Montana State University

The relationship between ethnic identity and racial-ethnic microaggressions among university students was evaluated. Racial/ethnic minority students completed a questionnaire including measures of ethnic identity and microaggressions. It was hypothesized that sense of ethnic identity is associated with lower scores on microaggressions, depression, and anxiety.

7 Students Reporting Low Quality of Sleep are Likely to Report Higher Levels of Stress

SPENCER BOLTZ, LILIANA ALVAREZ, STEVEN J. TERRY, AND COREY A. ENGLE

Metropolitan State University of Denver

The relationship between quality of sleep and stress levels were measured. Two hundred-sixteen students were administered online surveys assessing the two variables. A strong negative correlation was found between sleep quality and stress showing that as sleep quality decreased, stress increased. Faculty Sponsor: Kristen Lyons and Lisa Badanes.

8 Selfie Self-Esteem

NICK MARSING, RYAN LOFTHOUSE, SADIE EGBERT, KASSIDY BAIRD, AND CHELSIE CRANE

Snow College

The effect of posting selfies on self-esteem was examined. Forty students were asked to post an unflattering selfie on various social media sites every day for two weeks. Self-esteem was measured before, during and after the study. Comments and number of likes for subjects' pictures was also measured.

9 H.I.I.T. Your Body Image: The Effect of High Intensity Interval Training on Body Satisfaction

LIS MELCHIOR (1), CODY NEVINS (2), KELTON WHITTAKER (1), AND INGRID NYSTAD (2)

(1) Southern Utah University, (2) University of North Georgia

A study and literature review exploring the relationship of involvement in high intensity interval training and body image. Participants rated themselves on the The Body-Esteem Scale (Franzoi & Shields, 1984) both before and after participating in a high intensity interval training program. The procedures, results and implications will be discussed. Faculty Sponsor: Daniel Hatch.

10 Let's Talk About Sex: The Relationship between Sexual Education and Sexual Behaviors

ALEXANDRA KNOBLOCK, ERIN MOORE, AND CARA LANEY
The College of Idaho

The relationship between sexual education and the sexual behaviors and attitudes was examined. Participants (N = 183) were asked about their sexual education experiences, sexual behaviors, sexual attitudes, and negative consequences from risky sexual behavior. Comprehensive sexual education was associated with fewer negative consequences. Faculty Sponsor: Cara Laney.

11 Chronic Pain Acceptance, Pain Catastrophization and Post-Surgery Outcomes Among Utah Lumbar Fusion Patients

CASSIE DANCE AND SCOTT DEBERARD

Utah State University

The relationship between pain acceptance, pain catastrophization and post-surgery outcomes was explored in a sample of 101 workers'

compensation patients that had undergone lumbar fusion surgery. Higher activity engagement, pain willingness, and pain catastrophization were associated with less disability and greater mental and physical health.

12 The Effects of Sports Participation and Personality on Loneliness

JONATHAN GEARS, SAVANNAH SMITH, AND ROBERT DEMSKI

Adams State University

The effects on loneliness of being an athlete or not and introversion were explored. Forty-nine students completed the UCLA loneliness scale and a measure of introversion. The results showed that participants who were athletes and participants low in introversion were less lonely. However no interactive effect was found.

13 Persistence in Brain Lateralization Exercises

LAUREN M. PARSONS AND VICTORIA GIBSON

Colorado State University Pueblo

This study aims to measure the persistence level between three independent groups based on athletic involvement with brain lateralization exercises. It is hypothesized that the high athletic involvement group will demonstrate higher levels of persistence. In addition, the lateralization exercises will also influence level of persistence level. Faculty Sponsor: Krista Bridgmon.

14 Consumers' Psychological Understanding of Nutrition Labels in Regards to Nutrition Value

DANICA HARDWICK

Central Washington University

Individuals make food decisions multiple times a day, leading to food behaviors and patterns. However, many are unaware of what they are consuming due to the complexity of nutrition labels. A completely online preference survey was done measuring the comprehension of different food labels. We found that the food choice process incorporates many psychological factors including the ability to understand nutritional labels. Faculty Sponsor: Marte Fallshore.

15 No Difference in Maternal or Fetal Alcohol Content between B6 and D2 Mice

DAVID GILLIAM AND STEPHANIE DORMAND

University of Northern Colorado

Maternal and fetal alcohol levels were measured in B6 and D2 mice after intraperitoneal injection of 5.8 g/kg alcohol. No strain differences in alcohol content were detected at 30, 60, 120, and 240 minutes. Strain differences in alcohol teratogenesis cannot be attributed to differences in alcohol pharmacokinetics.

HISTORY/PHILOSOPHY/RELIGION, PERSONALITY PSYCHOLOGY
2:10-3:10PM, EVERGREEN ROOM

1 Religion, Spirituality, and Happiness

KELSEY H. S. ALLEN

Boise State University

The purpose of this study was to replicate and extend previous findings demonstrating a positive association between religion and happiness by incorporating spirituality into the measure of religion. 125 students completed a questionnaire. The results indicate religion, spirituality, and happiness are positively associated. Faculty Sponsor: Jennifer Weaver.

2 The Effect of Religiosity on Beliefs about Acceptance of Virtual Immortality

BLAKE TUBBS, CARLY LLOYD, CRYSTAL MARTINEZ, CHIKAKO TANAKA, KIM FERNANDEZ, AND JESSICA WOLFORD

Weber State University

Participants responded to a Religious Orientation Scale, and an assortment of evaluated statements regarding technology, robotics, and virtual immortality. 3 groups were found, split between high, medium, and low religious devotion/orientation. Pre/Post-test design failed to show major time effect. Differences were observed between groups and types of statements given. Faculty Sponsor: Aaron Ashley.

3 The Influence of a Religious Icon on Decisions Regarding Morality

AARON ASHLEY AND BRANDI CHRISTENSEN

Weber State University

The present study examines the effects of implicit priming, either a religious icon or a blank screen, on influencing the response for rationales on decisions regarding morality. Data suggest that there is no relationship between prime types (religious vs. none) on rationales.

4 Grit and Other Personality Correlates of Degree Commitment in College Students

WILLIAM DAVIDSON (1) AND HALL BECK (2)

(1) Angelo State University, (2) Appalachian State University

The study tested and confirmed the relationship between grit and degree commitment in 1,850 college students. Regression analysis confirmed the incremental validity of grit scores in predicting degree commitment after controlling for three other personality variables: academic efficacy, scholastic conscientiousness, and motivation to learn.

5 Selfies: The New Self-Portraits and Self-Esteem

LARISSA REYNOLDS

Southern Utah University

The relationship between “selfie” behavior on social networking sites and self-esteem was examined. 94 participants were administered a self-esteem survey and a selfie behavior survey. A correlation study was conducted, and no significant relationship was found between selfie behavior and self-esteem. Faculty Sponsor: Steve Barney.

6 Should I Stay or Should I Go Now? Optimism and Staying Behavior in Relationship Scenarios Involving Domestic Violence

KELSEY H. S. ALLEN, KIMBERLY R. HAYES, WHITNEY M. HERTER, AND KIMBERLY K. HARDY

Boise State University

Domestic violence is a common problem that usually occurs more than once within an abusive relationship. Optimism may be one factor associated with staying or leaving abusive relationships. We investigated if previous relationship abuse and dispositional optimism were predictive of staying behavior in hypothetical dating scenarios involving domestic violence.

7 Paranormal Belief, Fantasy Proneness, and False Recall

RICK STEVENS, MAGGIE FRANKLIN, FARAH SALEMEH, MARY MEDLIN, AND CAMILLE PEARCE

University of Louisiana at Monroe

The authors investigated the relationship of belief in the paranormal, fantasy proneness, and the Deese, Roediger, and McDermott false memory task. The results include a positive correlation between fantasy proneness and belief in the paranormal. The predicted relationship with those factors and false recall was not significant.

8 The Effects of Mindfulness Stress Reduction on Teenagers

TREVOR HICKS-COLLINS (1) AND JACOB HESS (2)

(1) Weber State University, (2) University of Illinois

The effectiveness of an 8-week Mindfulness-based Stress Reduction class for teenagers was examined in a randomized, controlled trial. Measures of depression, anxiety, attentiveness, overall well-being and stress-level showed consistent differences for the treatment group, compared to the wait-list control. Key findings and insights from this pilot study will be reported.

9 Social Factors of Gender and Sexuality

KARLIE HILL AND SARA BENDER

Central Washington University

Our team studies the nature of stigma as it relates to sexual and gender identity. We are interested in better understanding how individuals think about themselves secondary to their gender and sexual classifications as well as how these thoughts affect their interactions with others and their overall mental health. Further, we aim to identify effective interventions that minimize such stigma; consequently reducing prejudicial behaviors related to one's sexuality or gender.

10 Exploring Personality Characteristics, Academic Majors and Major Satisfaction

LAUREN STRAIN

Southwestern College

Seventy participants completed a survey exploring their personality, academic major choices and major satisfaction. Results found that individuals who chose majors for intrinsic reasons were more satisfied with their current major than students who chose for other reasons. Results also found that openness significantly differed among academic majors. Faculty Sponsor: Carrie Lane.

11 The Effects of Student Status and Self-Efficacy on Academic Mastery Goal Orientation

ELIZABETH MARINO, TARA GREBERT, AND ROBERT DEMSKI

Adams State University

This research explored whether being a non-traditional versus traditional student with high or low academic self-efficacy had an effect on academic goals. Ninety-seven students responded to measures of academic self-efficacy and academic mastery goals. Results showed main effects for student status and self-efficacy level. An interaction was not found.

12 Do Helpers Actually Help? The Effects Volunteerism and Personality on Bystander Intervention

NATHANIEL MARINO AND LAUREN MORENO

Texas A&M University Kingsville

The purpose of this study was to examine the relationship between personality, volunteerism and bystander intervention. Participants completed a personality questionnaire and listed their volunteer activities. During the experiment an emergency situation was simulated. Extroverts and more active volunteers were the least likely to help. Faculty Sponsor: Richard L. Miller.

DEVELOPMENTAL, MEASUREMENT AND EVALUATION

4:30-5:30PM, EVERGREEN ROOM

1 Relations Between Maternal Depression, Teen Well-being and Risk-taking

KAMILA KOURBANOVA AND JENNIFER M. WEAVER

Boise State University

The effects of chronic maternal depression on adolescent conduct problems and risk-taking behaviors were investigated. Data were used from the NICHD longitudinal study of Early Child Care and Youth Development (SECCYD). Regression analyses indicated maternal depression predicted internalizing and externalizing problem behaviors, lower social skills and risk-taking behaviors in adolescence.

2 Associations between Ethnic Identity and Adolescent Adjustment

CHRISTINA ROYAL AND JENNIFER M. WEAVER

Boise State University

Data from the NICHD Study of Early Child Care and Youth Development were analyzed to examine associations between ethnic identity and adolescent adjustment. Regression results indicated that positive ethnic affiliation measured at grade 5 was associated longitudinally with fewer internalizing behaviors and greater social skills at age 15.

3 Relations between Early Attachment Security and Later Peer Interactions

KIMBERLY R. HAYES and JENNIFER M. WEAVER

Boise State University

Data from the NICHD Study of Early Child Care and Youth Development (N=1,364) were examined for associations between attachment security and later peer interactions. Results indicated that a secure attachment at 36 months to mothers was predictive of positive peer interactions (though not negative/aggressive interactions) in the first grade classroom.

4 Perceptions of Breastfeeding Older Infants: Results of a Survey

Experiment

JENNIFER M. WEAVER, LAUREN M. MOORE, AND KIMBERLY

MCGOURTY

Boise State University

Attitudes about breastfeeding older infants were examined among undergraduate students through an online survey. Respondents were more negative about the benefits and appropriateness of breastfeeding older infants. They were more likely to agree that an infant could benefit from breastfeeding if they responded to an image rather than to text.

5 The Mediating Effect of Parenting on the Associations between Family Stressors and Child Behavior Problems

SU JUNG PARK, LORI A. ROGGMAN, AND YOON G. LEE

Utah State University

Pathways were examined from poverty to negative family environments to parenting to children's behavioral or academic problems. The link from family income to child behavior problems was mediated by negative family environment. Parenting had a partial mediating effect for the pathway from family income to child academic skills. Faculty Sponsor: Lori Roggman.

6 Shape Perception in Young Children

ELAINE AUGUSTINE

University of South Florida, Sarasota-Manatee

This study addressed whether young children can attend to and use part-shape and part-relation information- two aspects of shape similarity typical of adult object recognition. Children were asked to match objects using part-shapes and part-relations. However, they were able to match objects on only one aspect of shape similarity: part-shapes.

7 Adolescents' Guilt Proneness and their Emotional Arousal during Narratives of their Moral Transgressions

MARSHALL GRIMM AND STACIA BOURNE

University of Utah

To examine the relationship between guilt proneness and vocally encoded emotional arousal, we asked 40 adolescents (Mage = 16) to verbally narrate two events about times in which they hurt their peers. We examined the association between fundamental frequency range and adolescents' guilt proneness. Faculty Sponsor: Cecilia Wainry.

8 School Related Outcomes in Youth: Effortful Control Predicted Disruptive Classroom Behavior, Academic Efficacy, Academic Self-Handicapping, and School Grades

DOUGLAS E. COLEMAN, MARIA M. WONG, AND ELIZABETH A. CRAUN

Idaho State University

In an investigation of the utility of effortful control as a predictor of school behavior, 144 middle- and high-school students completed self-reports of self-regulation and provided subject-specific grade information. Additional grade information was obtained from teachers. After controlling for gender and ethnicity, effortful control significantly predicted several school related outcomes.

9 Relationship between Dyadic Cooperation and Compliance with Parent-Child Relationship

REMINGTON FARLEY

Boise State University

The relationship between compliance and dyadic cooperation and parent-child relationship was investigated in this study. Data from the NICHD SECCYD was used for this study. Dyadic cooperation at 24 months predicted mothers' positive relationship at 54 months and Autonomy at 24 months predicted for fathers' positive relationship at 54 months. Faculty Sponsor: Jennifer M. Weaver.

POSTER SESSIONS

10 Academic Dishonesty and Anonymity as Moderated by Ethnic Identity

JOSIAH HUGGINS

Northern Arizona University

The relationship between academic dishonesty and anonymity, as moderated by levels of ethnic identity, was examined. Participants were predominantly Caucasian freshman females, of traditional college age. Introductory screening found data suitable for multiple regression analysis. Preliminary findings suggested a strong link between academically dishonest intentions and behaviors. Faculty Sponsor: Nora Dunbar.

11 BrainWise Promotes the Development of Executive Functioning for Children from 1st through 5th Grade

DANIELLE DAWES, SABRINA NORWOOD, AND JULIANA ROSA

Colorado State University

The purpose of this study was to evaluate the BrainWise program at improving these skills in children between 1st and 5th grade. Based on the results from the current study, it was shown that the BrainWise can play a very beneficial role in helping students develop important skills to thrive in school, at home and with friends. Faculty Sponsor: Kimberly Henry.

12 Media Multi-tasking Across the Lifespan

MEREDITH MINEAR AND MARISSA ALBAT

University of Wyoming

We report the results from an on-line lifespan sample of 600+ individuals. Participants from ages 18 to 90 completed the Media Multi-tasking Inventory (MMI). Participants also completed measures of cognitive failures, sensation seeking, mindful awareness and environmental demands. We will examine generational differences in multi-tasking behaviors and predictors of multi-tasking.

13 Paternal Depression and Children's Development of Emotion Regulation

COLETTE EVANS, TY B. ALLER, AND LORI ROGGMAN

Utah State University

Does a father's mental health affect children's emotion regulation? Among 74 fathers the results show that depression predicted poor child emotion regulation at 24 and 36 months, taking into account maternal depression and family cumulative risk. This supports the need for legislative efforts to be directed toward fathering and child development.

FRIDAY PSI CHI EVENTS

7:30-9:00am, WHITE WATER ROOM

Psi Chi Welcome Coffee (Students and Faculty welcome)

Hosts: SUSAN E. BECKER, STEVEN MCKINLEY, Colorado

Mesa University, Special Guest: DR. EDDY AMEEN, American Psychological Association of Graduate Students.

Sponsored by Geico.

11:30am-1:00pm, CLEARWATER ROOM

Psi Chi Advisor's Luncheon (Invitation-Only Event)

1:00-1:55pm, WHITE WATER ROOM

Making the Leap: How Graduate School is Different from Being an Undergraduate

EDDY AMEEN, American Psychological Association of Graduate Students, DOUG COLEMAN, STEPHANIE KAPLAN, BARBARA WOODS ROBERTS, Idaho State University, AND SARA LYTER, Boise State University

When students first arrive at graduate school, culture shock can set in as expectations and norms for learning are starkly different from the undergraduate experience. A panel of individuals will reflect on lessons they've learned, and will share best practices for making the leap to graduate school. You will learn to not only survive, but thrive.

4:00-5:30pm, WHITE WATER ROOM

Psi Chi Award Winners Oral Paper Session

KRISTA BRIDGMON, Colorado State University, Pueblo AND ELIZABETH LIST, Northwest Nazarene University

Psi Chi Award Winners will receive their awards during the Psi Chi awards reception and raffle drawing (6:00 pm).

Perceptions of Stay-at-home Fathers and Attitudes Regarding
Traditional vs. Nontraditional Parenting Arrangements
LAUREN M. MOORE, JENNIFER M. WEAVER, AND CYNTHIA
CAMPBELL

Boise State University

Attitudes directed towards stay-at-home fathers and nontraditional parenting arrangements were examined in a sample of 447 undergraduate students through an online survey. Traditional gender role choices were viewed more favorably than nontraditional gender role choices regarding child care and males with essentialist attitudes about gender viewed stay-at-home fathers more negatively. Faculty Sponsor: Jennifer Weaver.

The Effects of Objectifying Statements on Women's Self-
Esteem, Mood, and Body Image
CARLY J. SCHWICKERT AND JESSICA L. MCMANUS
Carroll College

We examined how objectifying, beauty-oriented, and personality-oriented statements influenced self-esteem, mood, and body image. Female participants received objectifying, beauty-oriented, or personality-oriented statements made by males and reported feelings about him, self-esteem, mood, and body image. Objectification was associated with negative feelings about the male, lower body image, and positive mood.

The Relationship of Racial-Ethnic Microaggressions and
Alcohol Use Among College Students
ALYSSA M. SFERRAZZA, CHAZLYN A. MILLER, AND MONICA
C. SKEWES

Montana State University

We examined the relationship between racial-ethnic microaggressions and alcohol use among students of color at a predominantly White university. Thirty students of color completed questionnaires assessing microaggressions, alcohol involvement, and drinking motives. It is hypothesized that microaggressions will predict alcohol problems, and drinking to cope will mediate this relationship.

Perceptions of Police Coerciveness: The Effects of Suspect Race
and Expert Testimony

DREMA ROSEBERRY, MICHAELLA MENGHINI, KAYLLIE
PRATER, AND KRISTA FORREST

University of Nebraska at Kearney

We examined the effects of suspect race and expert testimony on mock jurors' perceptions of police interrogations and convictions. We found differences in ratings of interrogation techniques due to race. The presence of expert testimony appeared to have a significant effect on mock jurors' ratings of the interrogation techniques. Faculty Sponsor: Krista Forrest.

The Relationship Between Internet and Social Networking Site
Use and Sleep

COREY A. ENGLE, STEVEN J. TERRY, ANASTASIA M. BACCA, AND
KELSIE S. HOWELL

Metropolitan State University of Denver

The relationship between social networking site use and sleep was explored. Two hundred and eight participants completed questionnaires measuring social networking site use and sleep quality. While SNS use was not significantly correlated with sleep quality, we did find initial evidence that Facebook may be related to sleep problems. Faculty Sponsors: Lisa Badanes and Kristen Lyons.

Three or Four Course Stats and Research Method Sequence? A
Program Evaluation Study

STEVEN J. TERRY, COREY A. ENGLE, AND AARON S. RICHMOND

Metropolitan State University of Denver

A program evaluation to investigate the effects of condensing statistics and method curricula in statistics and research methods courses on academic performance (N = 431) and student ratings of instructors (N = 3385). Results for both academic performance and student ratings of instructors were significant.

6:00-7:00PM, WHITE WATER ROOM

Psi Chi Award Reception and Prize Raffle.

Hosted by SUSAN E. BECKER & STEVE MCKINLEY, Colorado
Mesa University, AND MARIA LAVOOY, Psi Chi International

All students welcome to come congratulate the award winners and enjoy the reception. Come in person to join in the competition to see if you win something special from Psi Chi.

FRIDAY WORKSHOPS

2:10-3:10PM, RAPIDS ROOM

Adolescent Brain Development and Substance Use/ Abuse: Implications for Decision Making and High Risk Behavior

STEVEN E. MEIER (1), DARTY MYRA (2)

(1) University of Idaho, (2) North Idaho College

Recent brain imaging techniques have identified significant differences between adolescent and adult brains. These brain differences appear highly correlated with adolescent risk-taking behavior. This workshop reviews these findings, then examines how substance abuse (including marijuana) alters brain development and ultimately, how those changes impact behavior.

2:10-3:10PM, WHITE WATER ROOM

Designing Materials for a Diverse World
COURTNEY ROCHELEAU AND ANNA ROPP
Metropolitan State University of Denver

How do we design materials for an increasingly diverse world? Drs. Rocheleau and Ropp will discuss what to consider when developing materials (including presentations, YouTube videos, and flyers) in order to make them accessible to a wide variety of people. If you produce any type of material – in or outside of the classroom – this presentation will help you reach a wider audience.

FRIDAY SYMPOSIA

10:20-11:20AM, CEDAR ROOM

Psychology Matters: Helping Undergraduates See Real-Life Connections to Psychological Content

R. ERIC LANDRUM (1), MAUREEN A. MCCARTHY (2), SUE FRANTZ (3), AND SUSAN A. NOLAN (4)

(1) Boise State University, (2) Kennesaw State University, (3) Highline Community College, (4) Seton Hall University

During this symposium, we make the case concerning the skills that undergraduate psychology majors should possess, starting with the Guidelines 2.0 foundational principles, continuing with the promotion of skills that will help students identify worthy sources of news, and concluding with tips to help students think scientifically about current events.

2:10-3:10PM, IVY ROOM

ELLIS-BATTIG MEMORY SYMPOSIUM

Using Action and Embodiment as Educational Tools
AARON ASHLEY

Weber State University

A litany of research suggests learning can be enhanced through the use of action during training. This research and its application potential will be discussed.

Multisensory information enhances memory for number in children

KERRY JORDAN

Utah State University

My research shows that multisensory stimuli boost memory for quantity during childhood. Redundant input may more effectively recruit attention and result in improved numerical learning.



INVITED SPEAKERS

William Douglas Woody, RMPA Alumni Address
9:10-10:10am

Erin Bigler, RMPA Distinguished Lecturer
10:20-11:20am

Lori James, G. Stanley Hall Lecture
1:00-2:00pm

Stanley Coren, Gardner Lecturer
3:20-4:20pm

PAPER SESSIONS

8:00-9:00am
Social Psychology III
Developmental Psychology

10:20-11:20am
Educational/School Psychology

1:00-2:00pm
Social Psychology IV

2:10-3:10pm
Health Psychology
History/Philosophy/Religion

2:10-4:20pm: RMPA Award Finalists

4:30-5:30pm
Memory and Cognition II
Personality Psychology II/Measurement
Teaching of Psychology II

POSTER SESSIONS

8:00-9:00am
Clinical/Counseling Psychology

10:20-11:20am
Industrial/Organizational; Military
Psychology; Psychology and the Law

1:00-2:00pm
Biopsychology/Psychopharmacology;
Population/Environmental

2:10-3:10pm
Social Psychology II

3:20-4:20pm
Psychology of Women/Gender;
Diversity; Cultural Psychology

PSI CHI TALKS

10:20-11:20am
Leadership Session: Transitions in
Chapter and Club Leadership

1:00-2:00pm
Chapter Exchange: Innovative
Philanthropy Idea Exchange

2:10-3:10pm
Chapter Exchange: Improving Your
Chapter's Fundraising Prowess

SYMPOSIUM

8:00-9:30am
Bell Loomis Environmental
Psychology Symposium

WORKSHOPS

9:10-10:40am
Increasing Knowledge and Detection
of Racial and Ethnic Microaggressions



SOCIAL NOTES ***

8:00-9:00am, White Water
Psi Chi Morning Coffee
All Welcome

11:30am-1:00pm, Loc. TBA
Teaching Planning Luncheon

2:10-3:40pm, Ivy
RMPA Psych Bowl

5:30-7:00pm, Cedar/ Evergreen
Business Meeting and
President's Reception
All Welcome

1:00-2:00pm
Art as a Mechanism to Enhance
Well-being

	ASPEN ROOM	CEDAR ROOM	EVERGREEN ROOM	WHITE WATER ROOM
8:00-9:00 AM			Clinical/Counseling Psychology	Psi Chi Welcome Coffee (8:00-9:00)
9:10-10:10 AM	RMPA Alumni Address Doug Woody			
10:20-11:20AM		RMPA Distinguished Lecturer Erin Bigler	Industrial/Organizational; Military Psychology; Psychology and the Law	Leadership Session: Transitions in Chapter and Club Leadership
11:30 AM-1:00 PM	LUNCH BREAK Teaching Planning Luncheon (location TBA)			
1:00-2:00 PM	G. Stanley Hall Lecture Lori James		Biopsychology; Psychopharmacology; Population/Environmental	Chapter Exchange: Innovative Philanthropy Idea Exchange
2:10-3:10 PM			Social Psychology II	Chapter Exchange: Improving Your Chapter's Fundraising Prowess
3:20-4:20 PM		Gardner Lecturer Stanley Coren	Psychology of Women/Gender; Diversity; Cultural Psychology	
4:30-5:30 PM				
5:30-7:00 PM		Business Meeting and President's Reception		

RIVERFORK ROOM	IVY ROOM	CLEARWATER ROOM	RAPIDS ROOM
Bell Loomis Environmental Psychology Symposium (8:00-9:30)	Social Psychology III	Developmental Psychology	
			Workshop: Increasing Knowledge and Detection of Racial and Ethnic Microaggressions (9:10-10:40)
	Educational/School Psychology		
Social Psychology IV		Workshop: Art as a Mechanism to Enhance Well-being	
RMPA Award Finalists	RMPA Psych Bowl (2:10-3:40)	History/Philosophy/Religion	Health Psychology
Teaching of Psychology II	Personality Psychology II/Measurement	Memory and Cognition II	



Dr. William Douglas Woody

University of Northern Colorado

What Can the Cold War Teach Us About Interrogation and Confession? Integrating Psychological Perspectives from the Mid-20th Century into Current Research

RMPA Alumni
Address
Saturday, April 11
9:10-10:10am
Aspen Room

Moderator:
Richard Miller

A currently underemphasized explosion of research occurred in the 1950s, during the complex milieu of post-World War II Europe and the United States. With the start of the Cold War, psychologists, psychiatrists, and other scholars evaluated the psychological factors that could cause high profile false confessions such as those by dissidents behind the Iron Curtain (e.g., Joseph Mindszenty in Hungary) and U.S. Marine Col. Frank H. Schwable, who falsely confessed to the use of biological weapons during the Korean conflict (Lifton, 1961; Meerloo, 1956). During this time in world history, scholars viewed confessions as resulting from several causes, including social influence (e.g., Lifton, 1961), physiological arousal and fatigue (e.g., Huxley, 1958/2004; Sargant, 1957), psychoanalytic needs to confess (Meerloo, 1951, 1956; Reik, 1959), or political pressures (Hunter, 1958). Although some of these scholars (e.g., Theodore Reik) have received some recent recognition for their contributions (see e.g., Houston, Meissner & Evans, 2014; Isreal, 2006; Weiss, 2012), others are largely absent from the current scholarship of interrogation and confession.

This talk will review 1950s-era perspectives on interrogation and confession, particularly false confession and connect those ideas to current scholarship. The presentation will conclude with historically justified recommendations for future research.



Dr. Erin Bigler

Brigham Young University

Networks, Connectivity and Neuropsychology

RMPA Distinguished
Lecturer
Saturday, April 11
10:20-11:20am
Cedar Room

Moderator:
Leslie Cramblet
Alvarez

Although post-mortem blunt dissection, as well as ultrastructure techniques, have long been used to examine neural pathways in the human brain, in vivo neuroimaging methods now permits the study of brain connectivity with great relevance to all of psychology and cognitive neuroscience. A variety of magnetic resonance imaging (MRI) techniques including structural imaging combined with diffusion tensor imaging (DTI), resting state functional connectivity mapping (rs-fcMRI) and functional MRI (fMRI) can be performed, some of which can be obtained during various behavioral or cognitive tasks.

How to integrate these methods in the study of cognition and behavior and the underlying neural networks that subserve them in the investigation of age-typical development, or some neurodevelopment, neurological disease and/or neuropsychiatric disorder will be reviewed. Understanding brain development from a systems neural connectivity and functional neural network perspective provides a much improved approach for using neuroimaging findings in the study of cognition and behavior. This lecture will review the current applications of neuroimaging methods for psychology and cognitive neuroscience.



Dr. Lori James

University of Colorado-Colorado Springs

*The Story of H.M.: Recent Findings
Indicating More than Memory Deficits*

G. Stanley Hall
Lecture
Saturday, April 11
1:00-2:00pm
Aspen Room

Moderator:
Leslie Cramblet
Alvarez

Many introductory textbooks on psychology present information about the amnesic patient H.M., widely known for his remarkably dense anterograde amnesia. In 1953, H.M. had an operation in which most of his medial temporal lobes were removed in an attempt to control his epileptic seizures, and from that time on, H.M. was unable to form new memories. He participated in hundreds of research projects over a span of more than 50 years, until his death in 2008. His deficit is typically characterized as a relatively pure case of anterograde amnesia, accompanied by some retrograde memory deficits.

However, over the last 15 years, published findings have begun to call into question the purity of H.M.'s memory deficit. Specifically, my colleagues and I have documented specific deficits in his language comprehension, language production, and visual cognition, and also identified some exacerbated age-related changes in H.M.'s non-memory cognitive processes. The research has definitely been controversial, especially regarding the mechanisms underlying H.M.'s deficits in domains other than memory, but the basic finding that H.M. may not have been a pure amnesic remains unknown to many psychologists who do not specialize in memory research as well as to the public at large.



Dr. Stanley Coren

University of British Columbia

The Intelligence of Dogs

Gardner Lecture
Saturday, April 11
3:20-4:20pm
Cedar Room

Moderator:
Steve Barney

Stanley Coren received his Ph.D. from Stanford University and is a professor (emeritus) in the department of psychology at the University of British Columbia, where he is also the director of the Human Neuropsychology and Perception Laboratory.

His research has covered many areas in psychology, including human vision and hearing, neuropsychology, brain, laterality, handedness, birth stress, sleep, behavior genetics and cognitive processing.

He is a prolific researcher and has published over 300 items, including articles in well-respected scientific journals including: Science, Nature, The New England Journal of Medicine, American Journal of Public Health, British Journal of Medicine, Psychological Review and others.

He has also published 14 books and monographs for professionals and students. Dr. Coren has won a number of awards for his research, and the quality of his contribution to science has been recognized by a number of major scientific organizations, including the American Psychological Association and the American Psychological Society. He has also appeared on Good Morning America and the Today Show.

SOCIAL PSYCHOLOGY III
8:00-9:00AM, IVY ROOM
MODERATOR: ANNA ROPP

Intrinsic, Extrinsic, and Quest Religiosity and Authoritarianism: Foundations for the Belief Structure Scale
COURTNEY A. ROCHELEAU (1), KEEGAN WALKER (1), AND NAHANNI FREEMAN (2)
(1) Metropolitan State University of Colorado, (2) Colorado Christian University

Historical measures of religious beliefs, including Right Wing Authoritarianism and measures of Religious Orientation (Intrinsic, Extrinsic, and Quest) have a number of problems. This study examined psychometric properties of a new Belief Structure Scale that addresses these limitations, providing evidence for reliability and validity. Results and implications will be described.

Perfectionism and Defense Mechanisms of a Religious Community
TYLER GRAFF, CAMERON JOHN, AND JARED STIRLAND
Utah Valley University

Perfectionism, defense mechanisms and religiosity were examined in a highly religious community to understand how they coexist. Two-hundred individuals were surveyed to see how religiosity plays a role in perfectionism and what the preferred defense mechanisms are of those with perfectionistic tendencies. Faculty Sponsor: Cameron John.

Stereotype Threat and Distance in Interracial Contexts: A Replication Study
EMILY WRIGHT, NICHOLAS SPENCER, ASHLEE WELSH, AND KIM KELSO
Adams State University

Stereotype threat and distance in interracial contexts was examined as part of a replication study. Eighty seven male participants were led to believe they would have a conversation with a Black confederate about love/relationships or racial profiling. Participants sat further away from the confederate when the topic was racial profiling. Faculty Sponsor: Kim Kelso.

The Assessment of Personality Traits Using Facial Expressions: What Do We Infer about Happy, Sad, and Angry Faces?
MARY RADEKE AND ANTHONY STAHELSKI
Central Washington University

This study examined inferences about the personality of two photographed individuals exhibiting three different facial expressions; happiness, sadness, and anger. Participants rated personality using the Minimizer personality scale (Saucier, 2002) and the Self-Assessment Manikin (Bradley & Lang, 1994) perceived attractiveness and facial maturity ratings varied according to facial expression and gender.

DEVELOPMENTAL PSYCHOLOGY
8:00-9:00AM, CLEARWATER ROOM
MODERATOR: CHERYL SANDERS

Aging in Saudi Arabia
NANCY J. KARLIN, JOYCE WEIL, AND WEJDAN FELMBAN
University of Northern Colorado

This study focuses on some of these societal elements using reports of the experience of aging from 52 older Saudi adults. These data suggest that with changing societal trends some elements of the aging experience may differ while many remain the same for the Saudi older adult.

Sensory Processing Specificity in Autism
JANNESSA KITCHIN
University of Northern Colorado

Sensory processing in autism was investigated. Twenty five parents of children diagnosed with autism, with ADHD, and without a diagnosis were asked to complete the Short Sensory Profile. The autism and the ADHD groups could be differentiated from the neuro-typical group but they could not be differentiated from each other. Faculty Sponsor: Nancy Karlin.

Can Fathers “Mother” their Children? The Negotiation of
Fathering Roles

CYNTHIA G. CAMPBELL AND SARA ALTON

Boise State University

This literature review integrates empirical evidence from several areas of study to explore how fathering roles are negotiated, both relationally and cognitively. It also demonstrates limitations to the conceptualization of mothering and fathering as inherently sex differences and reveals potential avenues for supporting more egalitarian parenting roles.

The Impact of Dolls on the Body Image of Young Girls

KENDAL A. CASSIDY, MELANIE E. TRENARY, CHERYL E.
SANDERS, LINDA L. LOCKWOOD, AND CHRISLYN E. RAN-
DELL

Metropolitan State University of Denver

Do Barbie dolls have an impact on girls? The effects of playing with a Barbie doll versus a more realistically-shaped doll were examined. Fifty three girls completed a body image assessment before and after playing with a doll. Results revealed significant differences in body image depending on frequency of play. Faculty Sponsor: Cheryl Sanders.

EDUCATIONAL / SCHOOL PSYCHOLOGY

10:20-11:20AM, IVY ROOM

MODERATOR: AARON S. RICHMOND

Instructor Status Influence on Academic Entitlement: Does
Instructor Status Matter?

SHEA SMART AND SCOTT MAY

Utah Valley University

Academic entitlement may be influenced by courses taught by full-time or adjunct instructors. Over 100 general psychology students were surveyed for academic entitlement, comparing classes taught by full-time and adjunct faculty. Both adjunct and full-time instructors were surveyed for instructor misbehaviors that lead to increased academic entitlement. Faculty Sponsor: Jessica Hill.

Involvement in Extra Curricular Activity by Home- and Public-
schooled Individuals during Childhood and Young Adulthood

ELISA POPE

Eastern Washington University

Comparison study of extracurricular (EC) activity involvement as a measure of socialization in eighty-three respondents aged 18-25 who were predominantly home- or public- schooled. Their participation in EC activities as children (5-17) and young adults (18-25) was assessed via an online questionnaire containing a series of activities, broken into five categories. Faculty Sponsor: Jillene Grover Seiver.

The Influence of Instructors Use of Humor on Perceived Learn-
ing and Interest in a Topic as Mediated by Student Gender

MOSHE MACHLEV AND NANCY KARLIN

University of Northern Colorado

Previous research has shown instructor gender differences in the use of humor influences students. The present study examined humor by considering the gender of students. Results suggest female students benefit more from humor on reported levels of learning and interest in the course topic. Faculty Sponsor: Nancy Karlin.

A Preliminary Analysis: Changing the Growth Mindset of 9th
Grade Students

BETHANY FLECK DILLEN, KELLY C. WRIGHT, AND AARON S.
RICHMOND

Metropolitan State University of Denver

A class entitled “Flex: Train your Brain” was taught at a 9th grade college readiness camp. Data was gathered through pre and post-test surveys. The Flex class increased growth mindset. Academic efficacy was increased and was higher for Flex students than the control. Results will be discussed in context of past research.

SOCIAL PSYCHOLOGY IV
1:00-2:00PM, RIVERFORK ROOM
MODERATOR: LINDA LOCKWOOD

Belief Perseverance and Attitude Polarization as a Function of Neuropsychological Indices: How Memory, Verbal Fluency, Attention, and Executive Functioning Impact Attitude Shift and Maintenance

NAHANNI FREEMAN, JENNA EELS, AND EVAN ROBERTSON
Colorado Christian University

Participants (n = 179) with more advanced skills in immediate auditory and visual recall and visuospatial construction showed higher belief perseverance. Barometers of executive function and inhibition showed that belief perseverance was higher when mental shifting was lower. Little attitudinal shift occurred for either theological or military issues.

Human-Animal Interactions: An Exploration of Attachment Theory and Attitudes Concerning the Treatment of Animals
KRISTIE MORALES

Metropolitan State University of Denver

Fifty-five participants were administered two questionnaires on attachment and the treatment of animals to investigate if anxious/avoidant attachment correlated with attitudes towards the treatment of animals. Results demonstrated that higher levels of anxious attachment were positively correlated with negative attitudes concerning using animals in utilitarian ways (i.e., food, research, etc.). Faculty Sponsor: Linda Lockwood.

Belief Polarization, Anxiety-induction, and Religiosity:
Moderators of Attitudes towards the Iraq War
NAHANNI FREEMAN AND JENNA EELS

Colorado Christian University

Participants (n=179) were randomly assigned to control, anxiety-induction guided imagery, or relaxation guided imagery groups. Following exposure to anxiety-provoking imagery, Ss showed greater belief perseverance. Ss with higher Quest, lower anxiety, and lower depression showed less belief perseverance. Ss exposed to calming imagery held more supportive attitudes towards war.

Individualist/Collectivist Orientation and Envy
CASSANDRA GONZALES, SUSAN TAKU, AND DEBANI GARZA
Texas A&M - Kingsville

The purpose of this study was to determine whether subjects (individualists vs. collectivists) become envious when observing other people getting flattered. Participants played headbans during which one participant received very positive feedback from the experimenter. The results indicated that collectivists rated their flattered opponent more negatively than individualists. Faculty Sponsor: Richard L. Miller.

HEALTH PSYCHOLOGY
2:10-3:10PM, RAPIDS ROOM
MODERATOR: COURTNEY ROCHELEAU

Knowledge of Nutrition and its Manifestation in Eating Habits
CALEY FEATHERSTONE
Boise State University

The present study sought to measure knowledge of nutrition in comparison to dietary habits and eating attitudes. We expect students' beliefs about nutrition to be inconsistent with actual consumption patterns. We believe individuals who score high on the EDI-3 will have more knowledge of nutrition, but will misuse the knowledge. Faculty Sponsor: Mary Pritchard.

The Effect of High and Low Glycemic Food Smells and Sights on Blood Glucose
LYNN H. WHITE, AFERDIT SADRIJA, INGRID E. NYSTAD, AND
DIANA J. WARD

Southern Utah University

Blood glucose responses can be classically conditioned to the sight and smell of food alone (sham feeding). We investigated whether this response could be differentiated based on the glycemic food index. Results suggest that high glycemic foods do elicit greater blood glucose responses to sham feeding than do low glycemic foods.

Parent Stress as a Predictor of Adolescent Feeding Patterns
KRISTINA DUNCOMBE, KAYLIE CARBINE, GINA BROWN,
AND CHAD JENSEN

Brigham Young University

We examined the relationship between parental stress and restrictive feeding patterns. Stress levels and feeding patterns were assessed three times over 6-months. Regression analyses indicated that higher levels of stress were related to increased restrictive feeding patterns. Intervention efforts targeting parental stress may be useful in reducing maladaptive feeding behaviors.

For Whom Should We Be Healthy? The Importance of
Prosocial Health Motivation

JORDAN D. HYDE (1), MATT HIATT (1), SAMUEL L. CLAY II
(2), AND JEFFREY S. REBER (1)

(1) Brigham Young University, (2) Brigham Young University - Idaho
This study investigated three questions. First, are individuals motivated to be healthy by the health benefits for self, others, or both? Second, how do healthy individuals believe that their health affects others? Third, how do individuals believe they are affected by the health of close others?

Faculty Sponsor: Jeffrey Reber.

HISTORY/PHILOSOPHY/RELIGION

2:10-3:10PM, CLEARWATER ROOM

MODERATOR: WILLIAM DOUGLAS WOODY

The Varieties of Religious Responses to Homosexuality Among
American Evangelicals: Growing Inclusion of Sexual Minorities?
JEFFREY A. PAUL

University of Northern Colorado

The historical trends toward affirmative stances in relation to the Lesbian, Gay, Bisexual, and Transgender (LGBT) community through the lenses of psychology and religion were analyzed. Responses to homosexuality in psychology, in the Pastoral Psychology literature, and among American evangelical Christians were explored in context. Faculty Sponsor: Doug Woody.

Religiosity, Relationship with LGBT Individual and their Effects
on Attitudes toward Same-Sex Marriage

JORDAN BYBEE

Weber State University

The effects of religiosity and relationships with LGBT individuals on attitudes toward same-sex marriage were examined. The study included 190 participants. Highly religious participants were less likely to support same-sex marriage, while having a close relationship with an LGBT individual increased the likelihood of supporting same-sex marriage. Faculty Sponsor: Theresa Kay.

How Long Does It Take To Recognize God?: A Speed Measure
Assessing the Validity of Religiosity

AUBURN BINETTE, ASHLEY HAYES, TODD BAIRD, AND
AARON ASHLEY

Weber State University

This study attempts to assess the construct validity of religiosity using a speeded lexical decision task. Participants judged whether stimuli (religious words, non-religious words, and non-words) constituted a word or non-word. We hypothesized individuals high in religiosity would be naturally primed for religious items and respond more quickly to them. Faculty Sponsor: Aaron Ashley.

Toxic Perfectionism in a Highly Religious Society

JARED STIRLAND AND ADRIANA ROSENBLAT

Utah Valley University

This study examines the relationship and dynamics of perfectionism in a highly religious society and the psychological associations between religiosity, perfectionism, and anxiety. Faculty Sponsor: Cameron John.

MEMORY AND COGNITION II
4:30-5:30PM, CLEARWATER ROOM
MODERATOR: KATHERINE HILL

Effects of Self-Deception on Memory for Nonverbal Symbols
KRISTIE HAUGEN AND MARC PRATARELLI

Colorado State University Pueblo

Behavioral markers of self-deception using nonverbal symbols were challenged with a subset of the studied stimuli. Participants responded incorrectly 32% of the time and RTs were 140 ms slower for denied stimuli. These findings suggest a cognitive mechanism causing the delay for denied stimuli may reveal a form of self-deception.

Effects of Self-Deception on the Processing of Visually Presented Words

SAMANTHA VILLANUEVA AND MARC PRATARELLI

Colorado State University Pueblo

Self-doubt is a form of self-deception. Participants studied 80 words and were later tested with a subset of 40. Unbeknownst to them, all appeared in the studied set. Results showed one-third of trials were denied and those stimuli produced a 50 ms delay. The delay may represent a self-deception mechanism.

The Effects of Restricted Field of View on Spatial Learning while Navigating

ERICA M. BARHORST, KRISTINA M. RAND, WILLIAM B. THOMPSON, AND SARAH H. CREEM-REGEHR

University of Utah

In many cases, peripheral vision is a vital aspect of successful navigation. In the first of a series of studies, we examined the idea that restricted peripheral field of view during navigation along unfamiliar paths should negatively influence spatial memory for object locations.

The Neural Bases of Synesthesia: A Brief Overview
RYAN COYLE

Metropolitan State University of Denver

Synesthesia occurs when a sensory stimulus that typically causes one perception involuntarily causes another perception at the same time – literally meaning “together perception.” This literature review discusses neurotransmission and cortical communication abnormalities found in synesthetes, in addition to data obtained from functional magnetic resonance imaging (fMRI) studies and case reports. Faculty Sponsor: Katherine Hill.

PERSONALITY PSYCHOLOGY II/ MEASUREMENT

4:30-5:30PM, IVY ROOM

MODERATOR: JAMES KOLE

An Interdisciplinary Approach to Understanding Honesty
KIMBERLY HARDY (1), STEPHEN CROWLEY (1), PATRICK BEACH (2), SARA COUTURE (3), KIMBERLY HAYES (1), DREW LINDGREN (1), MCKENZIE LYONS (1), JARED TALLEY (1), SHARLYNN THOMPSON (1), AND CAMILLE TIBBITS (1)
(1) Boise State University, (2) Coastal Carolina College, (3) Pennsylvania State University

The Honesty Project Lab investigates perceptions of honesty using both psychological and philosophical frameworks. Participants responded to open-ended questions investigating perceptions of honesty and dishonesty. Results indicate that exemplar, but rare, honest behaviors are different from perceptions of an honest person. This lab aims to investigate these findings further.

You Mean Self-Love Isn't Narcissism?

MARY E. PRITCHARD

Boise State University

The present study evaluated the validity of both a 30-item (short) version and 100-item (long) version of the the Self-Love Scale (Arylo, 2012). The results of three studies suggest that the self-love scale represents one cohesive factor, rather than 10 separate factors as Arylo (2012) originally proposed.

Predicting Grit through Locus of Control, Motivation, and Procrastination

KELTON WHITTAKER

Southern Utah University

Grit- “perseverance and passion for long-term goals”-is a personality trait related to achievement that can predict success better than talent. Little is known about how to promote it; understanding its relatedness to other constructs may help. Locus of control, motivation, and procrastination were examined as possible correlates and predictors. Faculty Sponsor: Bradley Gregory.

Grit: Does it have a Dark Side?

GWEN KELLEY, JODE KEEHR, AND RICHARD REARDON

University of Idaho

Male and female college students completed surveys which measured Grit, Machiavellianism, Emotional Intelligence, and Self-regulation. Individuals with medium-to-high scores on the Grit Scale were found to have low scores on the Emotional Intelligence scale which is contrary to the perception that gritty people are high in social intelligence.

TEACHING OF PSYCHOLOGY II

4:30-5:30PM, RIVERFORK ROOM

MODERATOR: LINDA LOCKWOOD

A National Survey of Career Advising for Psychology Majors: Are Faculty and Students on the Same Page?

AARON S. RICHMOND (1), STEVE BARNEY (2), DAN SEG-RIST (3), PAUL HETTICH (4), DEB BRIIHL (5), MICHAEL CLUMP (6), AND ERIC LANDRUM (7)

(1) Metropolitan State University of Denver, (2) Southern Utah University, (3) Southern Illinois University Edwardsville, (4) DePaul University, (5) Valdosta State University, (6) Rokhurst University, (7) Boise State University

In a national survey, both faculty and students described what they believed the best career advising. Surprisingly (or not), faculty and

students had some consistencies (e.g., need for a careers course) and some inconsistent responses (e.g., career fairs). Results will be discussed in the context of how to address the career advising needs for students.

Student-Client Relationships as a Mechanism for Promoting Critical Thinking through Service Learning

BRIANNA OSWALD AND CYNTHIA CAMPBELL

Boise State University

This study examines student-client relationships acquired through service learning to determine their relationships with changes in students' critical thinking skills. We expected that closer student-client relationships would be associated with more advanced problem solving skills, but that this relationship may depend on the quality of the service learning reflection.

President's Reception tonight!

Saturday, April 11, 2015

Join us for the RMPA Awards Presentation

and Business Meeting

5:30-7:00pm

Cedar/ Evergreen Room

CLINICAL/ COUNSELING PSYCHOLOGY 8:00-9:00AM, EVERGREEN ROOM

1 Insecure Attachment Styles and Complicated Grief Severity: Applying What We Know to Inform Future Directions
KIERSTEN M. EBERLE, LAURA K. SCHENCK, AND JEFFREY A. RINGS
University of Northern Colorado

A growing body of evidence supports links between attachment style, complicated grief (CG), and coping mechanisms in bereavement. However, much remains unknown regarding this complex interaction. This presentation provides a comprehensive synthesis of this literature base, culminating in several salient future directions for attachment-informed CG research, clinical assessment, and treatment.

2 Spirituality and Continuing Bonds in Bereavement: A Call for Further Research
JEFFREY A. PAUL AND KIERSTEN M. EBERLE
University of Northern Colorado

Historically, spirituality has been intertwined with the conceptualization of death and dying and continued bonds with the deceased. Despite this, little research has explored the implications of this connection. This presentation is a comprehensive depiction of this research thus far. Implications for psychologists and future directions are provided. Faculty Sponsor: Jeffrey Rings.

3 Telepsychology: A Call for Supervision and Training
JEFFREY A. PAUL AND OLIVIA STEVENSON
University of Northern Colorado

A systematic literature review on the use of technology in the practice of psychology was conducted. Telepsychology brings new legal and ethical considerations into practice. Training and supervision of this modality lags behind the great increase in practice. Implications and suggestions for training, practice, and research in telepsychology were given. Faculty Sponsor: Jeffrey Rings.

4 Self-Compassion and Subjective Well-being: A Meta-analysis
OLIVIA STEVENSON AND LIESEL CHRISTOE-FRAZIER
University of Northern Colorado

A meta-analysis was conducted to examine the relationship between

self-compassion and subjective well-being. Medium to large effect sizes were found between self-compassion and subjective well-being. Self-compassion may have great use in the field of counseling psychology. Unique implications of self-compassion for the practice and research of counseling psychology are discussed. Faculty Sponsor: Stephen Wright.

5 Attitudes and Willingness to Seek Counseling among College Students
WHITNEY HERTER
Boise State University

Frequently, people look at counseling as a last resort. It is unclear whether or not gender and culture affect an individual's decision to seek counseling. This study examines the effects of gender, culture, and stigma on one's attitudes and willingness to seek mental health counseling. Faculty Sponsor: Kimberly Hardy.

6. The Role of Religiosity, Cognition and Stress in Undergraduate Depressive Symptoms
GINA BEASLEY
Colorado Christian University

Sixty-four participants completed a novel instrument that assessed religious variables, future-oriented anxiety, optimism, and stress. Correlations between theoretically-derived subscales implied that spiritual experience and confidence may relate to decreased probability of depressive symptoms. Faculty Sponsor: Nahanni Freeman.

7 Effectiveness of Counseling in Influencing Attitudes Towards Seeking Help
M. GREEN, A. ALLEN, M. C. GENUCHI, AND A. A. SCHOTTELKORB
Boise State University

Negative attitudes towards seeking help are a barrier to engagement in counseling. This study was designed to investigate changes in attitudes towards help-seeking (AHS) after counseling and sex differences in AHS in college students. The study findings indicated that participant AHS were more positive after receiving counseling, and that women reported more negative AHS than men.

8 Differentiation of Self and Anxiety as a Function of Culture
KATIE PEASE (1), KURT D. BAKER (1), AND SAMUEL F. BAKER (2)
(1) California State University Stanislaus, (2) Brigham Young University

The relationship between differentiation of self, anxiety, and cultural identity was examined. One-hundred-fifty-two participants completed the State-Trait Anxiety Inventory, the Differentiation of Self Inventory, and the Self-Concept Scale. Differentiation of self was positively related to individualism and was the strongest predictor of anxiety (inversely). Anxiety was positively associated with collectivism.

9 Therapist Resiliency Theory: Implications for Therapists Working with Offense-Specific Clients
AMY DREIER, SEAN O'HALLORAN, DYLAN GHAFARI, AND STEPHEN WRIGHT
University of Northern Colorado

Seven mental health therapists who treat sex-offender clients participated in a qualitative (grounded theory) study on their therapeutic experiences. Therapist Resiliency Theory: Offense-Specific emerged advocating awareness of pitfalls and emphasizing the balancing of perspective, empathy, and boundary setting. The theory has implications for therapists entering and established in the field.

10 The Effects of Brief Counseling Associated with Coursework on Distress in Students
A. YODER, C. FEATHERSTONE, M. C. GENUCHI, AND A. A. SCHOTTELKORB
Boise State University

Psychological distress levels in college students are notably high, yet many students do not seek out formal counseling. The purpose of this study was to investigate a particular brief and low-risk form of counseling on distress in students. The results indicated that counseling resulted in decreased depression and overall distress.

11 Gratitude is Attitude
NATASHA LEWIS, GENESIS HERNANDEZ HASSAN, TARA SPAUGY, AND DANIEL HATCH
Southern Utah University

Gratitude has an impact on overall happiness. Previous studies have only

analyzed gratitude journaling for a 7-day period. The current study shows the effects of gratitude journaling over a three-week period. Findings suggest that three-weeks of journaling leads to a sustained boost to happiness. Results and implications will be discussed. Faculty Sponsor: Daniel Hatch.

12 Perfectionism and Loneliness in a Cultural Context
CHRISTOPHER IHLE, KELLY LAVIN, PARKER RHOMBERG, TALIA WOLKEN, YING SHANG DORIS ZHANG, CLARE JINZHAO ZHAO, AND RUTH CHAO
University of Denver

Our present study is the first in the field of Counseling Psychology to examine the moderation effect of racial/ethnic status on the association between perfectionism and loneliness. Among 195 White students and 173 Asian American students, our study found that Asian culture could be a buffer against concerns over mistakes, parental criticism and doubts about actions for Asian students.

13 Lowering Symptoms of Depression Through Exercise and Mindfulness Interventions
SPENCER MAGLEBY (1), CODY NEVINS (2), KASEY CORBRIDGE (1), AND SCOTT SHUMWAY (1)
(1) Southern Utah University, (2) University of North Georgia

We studied how high intensity interval training (H.I.I.T.) had an effect on depression. To do this we had 50 participants exercise using H.I.I.T. three times a week for 6 weeks and then recorded their depression score. The results of our study were significant, which have useful implications. Faculty Sponsor: Daniel Hatch.

14 Mindfulness and the Ironic Nature of Thought Suppression
BAHROZE RAKEEN AND CHRISTINA ERPELDING
Metropolitan State University of Denver

This study will explore the ironic nature of thought suppression, cognitive processes that facilitate it, and to determine if mindfulness meditation can be used to effectively suppress unwanted thoughts without ironic effects. Thirty three students will have their skin conductance levels measured while undergoing two conditions: thought suppression and meditation. Faculty Sponsor: Jovan O. Hernandez.

15 Stress and Loneliness: In a Taiwanese Context
 TALIA WOLKEN, PARKER RHOMBERG, KELLY LAVIN, YING SHAN
 DORIS ZHANG, CLARE JINZHAO ZHAO, AND CHRISTOPHER IHLE
 University of Denver

This study examined how Taiwanese handle stress and aims to determine (a) H1: whether self-esteem relates to self-kindness, (b) H2: whether self-esteem moderates the association between stress and loneliness, (c) H3a: whether self-kindness moderates the association between stress and loneliness; (d) H3b: whether self-kindness mediates the moderation of self-esteem on the association, and (e) H4: whether there is a 3-way interaction among stress, self-esteem, and self-judgment. Our findings support these hypotheses.

INDUSTRIAL/ORGANIZATIONAL; MILITARY PSYCHOLOGY;
 PSYCHOLOGY AND THE LAW
 10:20-11:20AM, EVERGREEN ROOM

1 Attitudes Toward Obesity and Their Effects on Discrimination
 in the Hiring Process
 HENDRIK OMBACH, LYNSI DRYSDALE, AND TODD BAIRD
 Weber State University

Participants were placed in the role of employer and were given one of four resumes, depicting an obese or nonobese man or woman. They then completed questions related to hiring likeliness, their attitudes toward obesity, and applicant personality characteristics. Results showed no discriminatory attitudes toward applicants.

2 Internet Usage, Personality, Narcissism, and Motivations for
 Facebook Usage
 CRYSTAL E. GARCIA, CORBIN J. STANDLEY, KAITLIN E.
 STAKER, LYNSI DRYSDALE, AND SHANNON MCGILLIVRAY
 Weber State University

Extant research purports that there are relationships between personality types and Internet and Facebook usage. To that end, the present study aimed to determine which personality traits, including narcissistic

traits, predict and motivate Internet and Facebook usage. Results reveal significant correlations between personality traits, narcissism, and types of Facebook usage. Faculty Sponsor: Shannon McGillivray.

3 Puzzled? The Effects of Goals on Puzzle Completion
 ROSANA MACIAS
 Southwestern College

Forty students were split into two groups to examine goal setting and performance on time to complete five different puzzles. A gender and goal setting interaction was found for one of the puzzles. Faculty Sponsor: Carrie Lane.

4 Felt Accountability and Task Interdependence as a Substitute
 for Leadership on Small Group Task Performance
 JOSEPH M. GOODMAN (1), GRANT C. CORSER (2), AND
 ELIZABETH D. GOODMAN (3)
 (1) Illinois State University, (2) Southern Utah University, (3)
 Brigham Young University

Research suggests that task interdependence does not always improve performance. The current study sought to replicate and extend Fandt's (1991) findings concerning the task interdependence and felt accountability effects on performance. Whereas Fandt found effects on subjective performance, our study supported an interaction on task performance. Individuals in the accountability and fully interdependent conditions performed best.

5 Initial Salary Expectations: Influences of Gender and Cognitive
 Style
 RICHARD REARDON, THOMAS COMSTOCK, ELIZABETH
 HOLBROOK, JODE KEEHR, GWEN KELLEY, BRADLEY LLOYD,
 AND BRICE WALKER
 University of Idaho

Male and female college students evaluated the salary prospects of male and female recent graduates in a job application scenario. Unexpectedly, both males and females favored the belief that female applicants can ask for more money, and can be offered more money, than male counterparts.

6 Guilt and Shame among Military Personnel and Veterans who have Experienced Military Sexual Trauma
 MIRA REYNOLDS, ANNABELLE O. BRYAN, AND CRAIG J. BRYAN
 National Center for Veterans Studies, University of Utah
 The association of MST and PTSD with guilt and shame in a sample of military personnel and veterans was investigated. 422 U.S. military personnel and veterans enrolled in college completed self-report measures. PTSD explained higher levels of guilt and shame in both men and women who experienced MST.

7 Social Support and Mental Toughness as Suicide Protective Factors in Military Police
 HILARY A. SMITH (1), ANDREA L. WOLFE (1), MARY MCNAUGHTON-CASSILL (2), AUGUSTINE O. OSMAN (2), AND CRAIG J. BRYAN (1)
 (1) National Center for Veterans Studies, University of Utah, (2) University of Texas, San Antonio
 The validity of the Mental Toughness Psychological Skills Profile was evaluated. We established its validity and considered the effect of social support sources on suicidal ideation among military police, while controlling for mental toughness. Social support sources accounted for the variance in the relationship between mental toughness and suicidal ideation.

8 Combat Exposure and Risk for Suicidal Thoughts and Behaviors Among Military Personnel and Veterans: A Systematic Review and Meta-Analysis
 CRAIG J. BRYAN (1), JAMES GRIFFITH (1), BRIAN T. PACE (1), KENT D. HINKSON, JR. (2), ANNABELLE O. BRYAN (1), TRACY A. CLEMANS (1), AND ZAC IMEL (1)
 (1) National Center on Veteran Studies, University of Utah, (2) Utah Valley University
 Twenty-one studies were analyzed and coded, looking for clarification on the issue of the relationship between combat and suicide. Results showed a 25% increased risk for suicide-related outcomes among those who have some type of deployment experience. However, deployment may not be sufficiently specific as a reliable predictor of suicide.

9 The Perception of Stress between Veteran and Civilian Populations
 BRETT C. CALDWELL AND SAM FINDLEY
 Southern Utah University
 We compared the results of 75 veterans and 75 civilians that took the Daily Hassles Scale-Revised, Social Readjustment Rating Scale, and participated in an experiment. We expect that veterans will perceive daily hassles as more stressful than civilians but will view major life events as less stressful. Faculty Sponsor: Steve Barney.

10 Psychological Distress and Access to Community Resources among Women in Prison
 MICHAEL B. MARES, CHRISTOPHER R. DECOU, AND SHANNON M. LYNCH
 Idaho State University
 Few studies have addressed access to community resources in incarcerated women post-release. This study examined differences in women's psychological distress across levels of employment, access to health insurance, and transportation. The present study found that employed women had lower psychological distress relative to unemployed women post-release. Faculty Sponsor: Shannon Lynch.

11 Improving the Accuracy of Lie Detection Through Personality Classification
 PAMELA F. CAMPBELL
 Northwest Nazarene University
 An examination was conducted regarding lying tendencies according to personality type. The study was performed utilizing a big-five inventory, the Sixteen Personality Factor assessment, and electroencephalogram (EEG) as mode of lie detection. Results revealed significant correlation between personality type and propensity to answer in a personality-specific manner during lie detection. Faculty Sponsor: Elizabeth List.

12 The Influence of Exposure to the Criminal Justice Systems on Blaming the Media for Criminal Behavior
NICK MARSING, VICTORIA BROWN, TREVOR OBERHANSELEY, LOGAN NIELSEN, AND HYRUM DAVIS

Snow College

The media is regularly blamed for influencing criminality. The current study examines if this blame is mitigated by how much exposure an individual has to the criminal justice system. When someone has more exposure to the CJ system does this inform their understanding of criminality such that they place less blame on the media.

13 Body Image and Experiences of Interpersonal Violence in Incarcerated Women

BAILEY E. PERSCHON, STEPHANIE P. KAPLAN, KAITLYN E. ADAMS AND SHANNON M. LYNCH

Idaho State University

This study will employ grounded theory approach to identify women's perceptions of how experiences of interpersonal violence (e.g. child abuse, partner violence, and sexual assault) are associated with body image in a sample of 47 formerly incarcerated women. Implications for programming while incarcerated and post release will be discussed. Faculty Sponsor: Shannon Lynch.

14 College Students' Perceptions of Rape

DOROTHY MOORE, LAURA GUTIERREZ, AND MARTE FALLSHORE

Central Washington University

Do participants know having sex with an intoxicated partner is rape? Will their perception of the crime's severity depend upon the sex of the intoxicated victim and sober perpetrator? We hypothesize that participants will not rate the scenario severely and severity ratings will differ depending on the dyad's makeup.

BIOPSYCHOLOGY; PSYCHOPHARMACOLOGY;
POPULATION/ENVIRONMENTAL
1:00-2:00PM, EVERGREEN ROOM

1 Sex Differences in the Relationship Shared by Sleep Disorders and Spinal Cord Injury

JENNIFER M. GRIGGS, JUNNY FOO, PENNIE S. SEIBERT, CODIEANN DEHAAS, DANIELLE NEBEKER, AND CHRISTIAN G. ZIMMERMAN

Saint Alphonsus Health System, Boise State University

The relationship shared by sleep disorders (SD) and spinal cord injury (SCI) is multifaceted, and is complicated even further by sex differences. 109 individuals with both SD and SCI were evaluated; while analyses of SD diagnosis were similar across sexes, psychological and physiological complaints differed.

2 The Complex Effects of Sex Differences on Deep Brain Stimulation for Treatment of Parkinson's Disease

SARAH MORTON, KAMILA KOURBANOVA, SUSAN ROBERTS, PENNIE S. SEIBERT, CODIEANN DEHAAS, AND DANIELLE NEBEKER

Saint Alphonsus Health System, Boise State University

Deep brain stimulation is the leading surgical intervention for movement disorders. Sex differences influence and complicate diagnosis, progression, and treatment. We conducted a longitudinal study (N=41) to investigate the physical, emotional, and social effects of this procedure. Men and women reported a different pattern of physical and psychological symptoms.

3 Behaviorally Inhibited Individuals Exhibit Reduced Acoustic Startle Response to a 50 ms, but not 500 ms White Noise Burst

EVA FONTAINE, DAVID WILLIAMS, AND M. TODD ALLEN

University of Northern Colorado
Behaviorally inhibited (BI) individuals have been found to exhibit enhanced eyeblink conditioning. This finding could be due to enhanced responses to the auditory stimulus. We explored the acoustic startle response (ASR) of inhibited and non-inhibited individuals. BI individuals expressed a reduced ASR eyeblink to a 50 ms white noise burst.

4 An Investigation of Fetal Alcohol Syndrome

ANA COLUNGA

Northwest Nazarene University

An examination of children afflicted with Fetal Alcohol Syndrome (FAS) was performed to attempt to pinpoint onset occurrence of specific symptomology. FAS BeST Survey was used to determine such symptoms of the participants. In regard to prenatal and postnatal diagnosis of FAS, there appears to be a significantly high accuracy for the screening. Faculty Sponsor: Elizabeth List.

5 Alcohol Withdrawal Symptoms Among College Students

JESSICA EGUSQUIZA (1), CATHERINE WILLIAMS (2), SARAH RIFFEL (1), AND PETER VIK (1)

(1) Pacific University, (2) Idaho State University

This study examined prevalence and correlates of alcohol withdrawal among college students. 98 students completed drinking and psychological symptom questionnaires. 22% experienced one or more alcohol withdrawal symptom. Symptoms correlated as expected with depression, drinking motivations, distress, and social anxiety. Findings indicate that withdrawal is a concern among college drinkers.

6 Big Five Personality Traits and Proenvironmental Attitudes and Behaviors

TARA WUERTZ

Walden University

The big five is the most widely used model of individual personality trait differences. This quantitative research study is being completed to discern if the big five personality traits of openness, conscientiousness, extraversion, agreeableness, and neuroticism are correlated with proenvironmental attitudes and behaviors.

7 Testing Attention Restoration in the Field

CARA MEYER, LAURA GRIGG, ALLISON CROSS, KELLI GLENN, CASEY HESTER, KATY WORMLEY, JAVIER MARTIN, AND WINFORD A. GORDON

Western Carolina University

This study measured attention restoration in the field. The measure was the Reversible Figure Test (RFT). People who came to a wilderness park to go hiking were volunteer participants. The changes in attention were also related to the perceived restorative potential of the setting by using the Restorative Potential Index. Faculty Sponsor: Winford A. Gordon.

President's Reception tonight!

Saturday, April 11, 2015

*Join us for the RMPA Awards Presentation
and Business Meeting*

5:30-7:00pm

Cedar/ Evergreen Room

SOCIAL PSYCHOLOGY II
2:10-3:10PM, EVERGREEN ROOM

1 Changing Portrayals of Parents in Entertainment Media
NICK MARSING, CARLY GRAYSTON, RILEY STEADMAN,
ADDIE BEST, AND ISAI WILLEMSE
Snow College

The portrayal of parents in entertainment media throughout decades for varying target demographics was assessed. Trained researchers viewed television programs and recorded how parents in varying television series were portrayed and how they have changed over time. Short, one word, outside opinions were also solicited on the topic.

2 How Others Perceive Bullying: Some Effects of Gender and Bullying Tactics
BRADLEY A. LLOYD
University of Idaho

The perceptions of college students on school bullying tactics employed by the aggressor was investigated. 86 students were given a questionnaire regarding bullying tactics and gender. Males were perceived to be involved in physical bullying more often, while females were perceived to be involved in electronic bullying more often.

3 Perception of Gender in Risky Driving Behaviors
WESLEY HARRIS, SARAH CHUNG, KEVIN BAER, RICKY
CANADO, AND MATTHEW A. HIATT
Brigham Young University

We explored people's perceptions of how often males and females perform risky driving behaviors. A pilot revealed that males and females rate themselves as engaging in less risky behaviors. Males tended to rate both genders as performing equal amounts of risky behaviors. Females tended to rate males as riskier drivers. Faculty Sponsor: Jeffrey S. Reber.

4 Ambiguity in Romantic Relationship Terminology and its Impact on Relationship Satisfaction
DAKOTA WILSON, NICK MARSING, CAMERON MAYLETT,
BREA DINEHART, AND TORREY LARISCH
Snow College

The effects of ambiguity in relationship terminology and how they impacted relationship satisfaction were examined. Surveys were administered to people of all age groups to analyze their definitions and ideas about certain relationship terms. Data found that age and religion significantly impacted the terminology used.

5 Because She's on the Track Teams, She's not Fat, Unhealthy, Lazy, etc.: A Social Cognitive Bias in Health-Related Person Perception Evaluations of a Female
GRANT C. CORSER (1), MATTHEW SCHMIDT (1), AMBER SHARKEY (1), JOSEPH M. GOODMAN (2), AND ELIZABETH D. GOODMAN (3)
(1) Southern Utah University, (2) Illinois State University, (3) Brigham Young University

After viewing a female photo, participants made evaluative judgments about her health-related and behavioral attributes. Participants viewed what appeared to be an obese, average or thin sized female. Photos labeled the female as an athlete, college student, or diseased. Results demonstrated a bias according to labeled social-cognitive information.

6 Facebook and Personality Perception
KORTNEY BROTHERS, MARIA CUNNING, AND TODD C. BAIRD
Weber State University

Participants reviewed one of ten Facebook profiles and indicated their perception of the Facebook user's personality by completing the Big Five Personality Inventory. Analyses indicated significant differences between the self-reported personality of the Facebook user and the participant's perceptions of them based on their Facebook profile. Implications will be discussed.

7 An Examination of Implicit Associations Between Poverty and Immorality

BRIAN DRWECKI AND KIRSTEN BELL

Regis University

The effect of poverty priming on moral reasoning was examined. 70 students were primed with thoughts of poverty, completed two moral dilemmas, and a poverty-immorality IAT. Preliminary results suggest a moderate to strong cultural association between poverty and immorality.

8 The Effects of Dance and Classical Music on Emotion

JAMES FULKS

Brigham Young University - Idaho

Prior research shows there is a correlation between the characteristics of people who like certain types of music. I wanted to add to the evidence that music affects behavior, by testing how emotions are effected by music. We found that listening to music increases positive emotions and reduces negative emotions. Faculty Sponsor: Eric Gee.

9 The Relation between Self-Control and Social Conformity

JENNIFER L. DELANGE, ANASTASIA M. BACCA, BRANDON GALE, AND IAN A. MAXWELL

Metropolitan State University of Denver

The present study investigated the relation between individual differences in self-control and conformity. Conformity was assessed using a picture ratings task, and participants completed a self-report measure evaluating trait levels of self-control. As predicted, a significant negative correlation was found between self-control and the tendency to conform. Faculty Sponsor: Lisa Badanes.

10 Material Aspirations of College Students over Time

STEVEN CLARK, MICHAEL OLSON, CHELSEY HICKEN, AND ALEX SIMON

Utah Valley University

College students were surveyed in 2014 as a follow up to a 2003 survey to determine whether material aspirations had been affected by the great recession. While there were differences between the samples, both groups had unrealistically high aspirations for number of homes and salary.

11 Insecurity and Rumination as Predictors of Relational Aggression in Young Adults' Romantic Relationships
SAVANAH MAURTUA, CYNTHIA CAMPBELL, AND CHANTAL MARTINEZ

Boise State University

Relational aggression in young adult romantic relationships is an important, but understudied, phenomenon. The present study examines how rumination and insecurity are related to relational aggression perpetration in young adults' romantic relationships. Sex differences in the correlates of relational aggression are also examined.

12 The Role of Social Norms Related to Gender in Helping Behaviors among College Students

MICHAEL PATTERSON, TIMOTHY RICKETSON, AMBER ANTHENIEN, AND JENNIFER HARMAN

Colorado State University

This study aimed to investigate whether social norms related to gender roles predict helping behaviors. Students' attempts to help a confederate enter a building while carrying a large box were coded. No significant differences in helping between genders were found. Future researchers should determine whether findings reflect the bystander effect. Faculty Sponsor: Jennifer Harman.

13 Effects of Gender and Solitude on Mobile Device Dependence

JOSH BROWN, KRISTIE HAUGEN, AND MARC PRATARELLI
Colorado State University Pueblo

We examined the effects of gender and solitude on mobile device dependence. The elapsed time before each participant interacted with a mobile device after being left alone was recorded and analyzed. Results yielded a marginal effect of gender and males were quicker to interact with their mobile devices than females.

14 Injunctive Normative Messages and Effective Visual Aids
 PERLA SANDOVAL, PATRICIA A. ALOISE-YOUNG, JENNIFER E. CROSS, RANDY PERKINS, AND OLIVIA GEORGIA
 Colorado State University

The effectiveness of various visual injunctive normative messages was examined as well as conservation behavioral intent. Participants were randomly shown 1 of 4 images; no image, a light switch, a happy/sad group of students, or a smile/frowning emoticon. There was a significant main effect of comparative norm condition on future conservation behavioral intent and ratings of approval of conservation behavior. Faculty Sponsor: Patricia Aloise-Young.

15 Because of Snapchat: Anonymity vs. Permanency as Predictors of Behavior
 NICK MARSING, CHASSIK COOK, CHELSEY PETERSEN, JORDAN BUMGARDNER, AND WESTON MECHAM
 Snow College

The current research evaluates how current trends in social media apps such as Snapchat might be giving new insight into why individuals would commit negative interpersonal actions. The question of permanency of consequences is evaluated against the more traditional anonymity of actor to see which is more influential in committing such acts.

PSYCHOLOGY OF WOMEN/GENDER; DIVERSITY;
 CULTURAL PSYCHOLOGY
 3:20-4:20PM, EVERGREEN ROOM

1 Gender Considerations in Attitudes toward Help-Seeking and Depression in Greek Students
 LIA SOFTAS-NALL (1), SARA HOFMANN (1), MARIA PLATSIDOU (2), RACHEL HAUG (1), AND SOFIA SOFTAS-NALL (1)
 (1) University of Northern Colorado, (2) University of Macedonia
 The current study explored gender considerations in relation to attitudes toward help-seeking, stigma, and depression in a sample of Greek students. Three hundred and seventy-two university students participated.

Women reported higher levels of depression when compared to men. Implications and attitudes toward help-seeking will be discussed.

2 The Effects of Gender and Ethnicity on Attitudes Towards Women's Social Roles
 DARIANNA ROYBAL, JENNIFER MAEZ, AND ROBERT DEMSKI
 Adams State University

The effects of gender and Hispanic or Caucasian ethnic identity on attitudes towards women's social roles were examined. One-hundred nineteen college students completed the Attitudes Toward Women Scale. Results showed that gender and not ethnicity had a stronger liberalizing effect on attitudes toward women's social roles.

3 Which Group is More Likely to be Accepting of their Potential or Current Significant Other Viewing Pornography Regularly, Single Individuals and Those in a Committed Relationship?
 CHRISTYAN GUDJENOV
 Utah Valley University

The relationship between single individuals and those in a committed relationship were examined to determine which group would be more accepting of their potential or current significant other viewing pornography regularly. A survey was used to determine results. Single males were expected to be most accepting. Faculty Sponsor: Cameron John.

4 Hey Baby, Hey Baby, Hey: The Impact of Pregnancy on Body Image
 TAVINIA TUCKER
 Southwestern College in Kansas

Seventy-four mothers were surveyed on body image during different trimesters of their past pregnancies. It was predicted that as pregnancy progressed through trimesters, the level of body image would increase. However, researchers found women in later trimesters had more negative body image. Several other variables also significantly impacted body image. Faculty Sponsor: Carrie Lane.

5 Perception of Female Perpetrated Domestic Violence
 NATHAN GARDNER, NIWAKO YAMAWAKI, CLAUDIA RAS-
 MUSSEN, MARY COOK, ANDREW STRATFORD, CASSIE
 WIDDISON, NANNETTE VERNON, SARAH CHUNG, JASON
 WOODRUFF, AND KEVIN RUSHTON

Brigham Young University

We examined perceptions of female perpetrated domestic violence by having students answer a questionnaire. Those who read the female perpetrator/male victim scenario, and male participants in general, blamed the victim more and imagined the body shape of the female as being bigger than if the roles were switched. Faculty Sponsor: Niwako Yamawaki.

6 Assessing Claims of Body Image Fear Strength
 NICK MARSING, AUSTIN HERNANDEZ, DAVID EDLUND,
 ERIC WOODBURY, TODD GRIFFITHS, AND JORDIN KIRKHAM
 Snow College

The study examines claims made about women's fears of gaining weight. A two part survey provides hypothetical situations dealing with body image related fears as well as more concrete and abstract fears. It identifies trends in how pervasive certain fears in relationship to others based on the domain of the fear.

7 Religiosity, Personality, and Attitudes toward Homosexuality
 CORBIN J. STANDLEY

Weber State University

The current study utilized a correlational survey methodology comprised of three subscales to examine the interplay between religiosity, personality dimensions, and attitudes toward homosexuality. Significant correlations between religious activity and negative attitudes toward homosexuality as well as between the Openness to Experience personality dimension and positive attitudes are anticipated. Faculty Sponsor: Theresa Kay.

8 Incarcerations Inequities of African Americans in Black
 Versus White States

JOSEPH HORVAT AND CELESTE MCCLANNAHAN

Weber State University

There has been an increased concern over the obvious disparities between White and African American penal incarcerations (NAACP Fact Sheet, 2013). Using official data from predominantly Black versus predominantly White states incarceration rates for African Americans were significantly higher in White States when compared to Black States.

9 Undergraduate Student Change in Colorblind Racial
 Attitudes: Impact of a Multicultural Psychology Course
 CHRISTINA PATTERSON AND MELANIE DOMENECH-
 RODRIGUEZ

Utah State University

A total of 76 undergraduate students completed an upper division multicultural psychology class at a PWU over the course of two fall semester classes, 2013 and 2014. Results discuss change in colorblind racial ideology and the moderating effects of sociocultural empathy and multicultural experiences on colorblindness. Faculty Sponsor: Melanie Domenech-Rodriguez.

10 Working Alliance, Race/Ethnicity, and Psychological Distress
 CLARE JINZHAO ZHAO, YING SHAN DORIS ZHANG, TALIA
 WOLKEN, PARKER RHOMBERG, KELLY LAVIN, CHRISTOPHER
 IHLE, AND RUTH CHAO

University of Denver

Research studies have established a significant relationship between working alliance and clients' psychological distress. Working alliance includes three key aspects of therapeutic coalition: (a) agreement on the tasks of therapy, (b) agreement on the goals of therapy and (c) development of an affective bond. We look a clients' race/ethnicity in relation to the key aspects of a working alliance and the impact on a client's psychological distress.

11 Self-Concept Clarity: The Effects of Multiculturalism
 MARGARITA MADERA AND CRISTINA FLORES

Texas A&M - Kingsville

The purpose of this research was to examine the self-concept clarity of multicultural individuals. Participants completed a self-concept clarity Self-concept clarity was less for individuals whose parents came from two different cultures as compared to those with parents from the same culture. Faculty Sponsor: Richard L. Miller.

12 Labors of Love: Stereotypical Labor Division in Strong Appalachian Marriages

OLIVIA MORENO (1), KELTON WHITTAKER (1), ZANIA NICHOLSON (1), TORALF ZSCHAU (2), AND DANIEL HATCH (1) (1) Southern Utah University, (2) University of North Georgia
 Predominantly, previous research on the Appalachian subculture has focused on negative aspects of the culture. To develop a more balanced theoretical framework of Appalachian culture, our qualitative study focused on the characteristics of successful marriages in the Appalachian region to see how gender roles have changed or stayed the same. Faculty Sponsor: Daniel Hatch.

13 Is Love All You Need? Trust and Respect in Strong Appalachian Marriages

ZANIA NICHOLSON, KELTON WHITTAKER, OLIVIA MORENA, TORALF ZSCHAU, AND DANIEL HATCH
 Southern Utah University
 Research concerning Appalachian culture has often focused on negative aspects. In the current research, positive attributes were examined through qualitatively focusing on strong marriages in Appalachia to explore which factors contributed to strength in marriage. Trust and respect are overwhelmingly common themes that seem to be indicative of healthy marriages. Faculty Sponsor: Daniel Hatch.

14 Reentry Transition upon Coming Home: Successful Factors of Studying Abroad

KIMBERLY BENSON AND DANIELLE NIEMELA
 Southern Utah University
 As the world today is becoming more globalized, it's essential that individuals broaden their perspective becoming knowledgeable of cultures. A popular way students are gaining a culture edge is through studying abroad. Transitions of studying abroad are well documented, except for the final stage of reentry. Successful studying abroad will result in reverse culture shock upon coming home. Our research examines how to create a successful study abroad experience by examining factors causing reverse culture shock. Faculty Sponsor: Grant Corser.

15 Suicidal and Non-Suicidal Thoughts and Behaviors among Adolescent Survivors of Commercial Sexual Exploitation Living in Cambodia

KIRSI WHITE, TRACY CLEMANS, AND CRAIG BRYAN
 National Center for Veterans Studies, University of Utah
 The present study examines rates of suicidal thoughts and behaviors (STB) among survivors of commercial sexual exploitation in Cambodia. 13 female adolescent participants (ages 14-19 years) completed structured STB interviews. Results provide information on rates of STB in an ethnically diverse sample exposed to sexual trauma.

President's Reception tonight!

Saturday, April 11, 2015

*Join us for the RMPA Awards Presentation
 and Business Meeting*

5:30-7:00pm

Cedar/ Evergreen Room

10:20-11:20AM, WHITE WATER ROOM

Leadership Session: Transitions in Chapter and Club Leadership

SUSAN E. BECKER, Colorado Mesa University, AND MARIA LAVOOY, Psi Chi International

Every academic year brings changes and challenges to Psi Chi chapters and affiliate clubs. Changes in student leadership presents challenges to faculty, and changes to faculty adviser-ship presents challenges to the student leaders. We will present best practices in student leadership development, and guidance for how to smooth the leadership transitions. Model Chapter requirements will be discussed.

1:00-2:00PM, WHITE WATER ROOM

Chapter Exchange: Innovative Philanthropy Idea Exchange
ROBYN AGUERO, VICTORIA GIBSON AND LAUREN PARSONS, Colorado State University-Pueblo, JENNIFER SEIDERS AND LUKE MERRILL, Northwest Nazarene University.
Moderators: KRISTA BRIDGMON, Colorado State University-Pueblo AND ELIZABETH LIST, Northwest Nazarene University

All members of Psi Chi and Psychology Club organizations are invited to join in group idea exchange involving chapter philanthropy. The session is informal and designed for utmost interaction among those in attendance. You will leave with innovative ideas of how your chapter can give back or pay forward.

2:10-3:10PM, WHITE WATER ROOM

Chapter Exchange: Improving Your Chapter's Fundraising Prowess
LINDSEY WHEELER, CHRISTINA RUDZINSKAS, COREY ENGLE, LISA BROWN, AND MARIA JOSE YTTERBERG, Metropolitan State University of Denver, ROGER CLAEYS, MIKE CLARK, HANNAH LISS AND STEVEN MCKINLEY, Colorado Mesa University

Moderator: AARON RICHMOND, Metropolitan State University of Denver

Gather with fellow chapters to discuss the challenges of fundraising and glean new and innovative ideas to improve your chapter's fundraising in the future. Time tested methods of fundraising will be presented by officers from two of the region's most successful chapters.

SATURDAY SYMPOSIUM

8:00-9:30AM, RIVERFORK ROOM

BELL LOOMIS ENVIRONMENTAL PSYCHOLOGY SYMPOSIUM

MODERATOR: NANCY KARLIN

Visual and Auditory Effects of Tour Overflights on Natural Landscapes

BRITTON MACE (1), STUART CLEMENTS (1), KAITLIN POTTER (1), GRANT CORSER (1), AND JAKE DENISON (2)

(1) Southern Utah University, (2) University of Tulsa

Visual and auditory effects of propeller planes and helicopters on natural landscapes were compared in a laboratory simulation. Participants served in one of seven conditions and evaluated scenes and sounds on six dependent variables. Results show the sight and sound of helicopters and propeller airplanes in natural environments cause negative evaluations.

Baseline Soundscape Conditions at Grand Staircase-Escalante National Monument

STUART CLEMENTS, ALEX VITTUM-JONES, LARISSA REYNOLDS, JENNIFER ANDERSON, AND MICHELLE EWEN

Southern Utah University

Acoustic monitoring at four locations in the Grand Staircase Escalante National Monument collected baseline sound levels. This data was used to identify specific sound sources-both ambient and anthropogenic-sound pressure levels, frequencies, and amplitude to provide a complete representation of the soundscape surrounding each acoustic monitor.

Retention in the Eye of the Student: The Role of a Beautiful Campus

STUART CLEMENTS (1), KAITLIN POTTER (1), BRITTON MACE (1), AND STEVEN ELIAS (2)

(1) Southern Utah University, (2) New Mexico State University

The perceived scenic beauty of a campus has been found to have a significant indirect effect on affective commitment and turnover intention. When students find their college campus to be aesthetically pleasing, their satisfaction with the university goes up, resulting in greater psychological attachment and decreased desire to withdraw from the university.

SATURDAY WORKSHOPS

9:10-10:40AM, RAPIDS ROOM

Increasing Knowledge and Detection of Racial and Ethnic Microaggressions

CHRISTINA PATTERSON AND LESTHER PAPA

Utah State University

The workshop will provide information on the brief history of racism with emphasis on modern racism, a definition and taxonomy of racial microaggressions, and impacts of racial microaggressions utilizing media examples from television, movies, and web-based programming. Ideal for White populations but all are encouraged to attend.

1:00-2:00PM, CLEARWATER ROOM

Art as a Mechanism to Enhance Well-being

LAURA ASH, GABRIELA OLIVAS, TARA HEGG, AND TRAVIS HEATH

Metropolitan State University of Denver

The benefits of art on well-being were researched. Dance, creative writing, drawing, and simple crafts have all been shown to enhance a person's well-being. Art can be a useful tool in combination with typical talk therapy.

Thank you!



Teresa Taylor



Kimberly Hardy

The Rocky Mountain Psychological Association would like to thank Teresa Taylor and Kimberly Hardy of Boise State University for serving as Convention Managers for this year's meeting.

This conference would not have been a success without their amazing efforts!

RMPA DISTINGUISHED SERVICE AWARDS

In 1978 the Association started a procedure whereby members of the Association who have given their time and efforts over and above that which would be normally required should receive special recognition. That year, the Association established a Distinguished Service Award which was a small means whereby individuals could be afforded special recognition. Since that time several individuals have been so honored. The honorees are:

1978	Bernard Spilka	University of Denver
1981	Ralph D. Norman	University of New Mexico
1982	William H Brown	Utah Psychological Center
	Alice R. Fehrenbach	Denver, Colorado
	Wilson J. Walthall	University of Wyoming
	Helen Wilson	Eastern Montana College
1983	Irwin H. Cohen	V.A. Hospital, Denver, Colorado
	Henry C. Ellis	University of New Mexico
	W. C. Leiding	Lovelace Medical Center
	Earl E. Swartzlander	Denver, Colorado
1984	Robert H. Bruce	University of Wyoming
	Harrie F. Hess	University of Nevada, Las Vegas
1985	Paul Porter	University of Utah
	Sheila Dietz	Colorado State University
1986	Janet Wollersheim	University of Montana
1987	Richard G. Weigel	Colorado State University
1988	W. C. Leiding	Lovelace Medical Center
	David Thomas	University of Colorado, Boulder
	Harl H. Young	Metropolitan State College
	Michael Wertheimer	University of Colorado, Boulder
1989	Sara Lyon James	SE Wyoming Mental Health Center
	Neil Bartlett	University of Arizona
1991	Theodore H. Cutler	University of Denver
1992	Len Haas	University of Utah
1993	Janet Kay Schnorr	Northern Arizona University
1994	Michael Wertheimer	University of Colorado, Boulder
1995	Robert L. Atwell	Denver, Colorado
1996	Karen E. Ford	Mesa State College
1997	William Wallace	University of Nevada, Reno
1998	Susan Bromley	University of Northern Colorado
	William J. Wozniak	University of Nebraska at Kearney
1999	No award given	
2000	Paul A. Bell	Colorado State University
2001	Kenneth Nikels	University of Nebraska at Kearney
2002	Pennie Seibert	Boise State University
	Roger Fouts	Central Washington University
2003	Rick Miller	University of Nebraska at Kearney
2004	Mitch Handelsman	University of Colorado at Denver
	Wayne Viney	Colorado State University
2005	Diane Martichuski	University of Colorado Boulder
2006	Alice Healy	University of Colorado Boulder
2007	Michelle Butler	U.S. Air Force Academy
	Mark McDaniel	Washington University
2008	Nancy Karlin	University of Northern Colorado
2009	Ross Loomis	Colorado State University
2010	Judith A. Sugar	University of Nevada Reno
2011	Cheryl Sanders	Metropolitan State College of Denver
2012	Eric Amsel	Weber State University
2013	William Douglas Woody	University of Northern Colorado
2014	Robert Rycek	University of Nebraska at Kearney

Rocky Mountain Psychological Association Presidents (1930-2017)

1930/31 Lawrence W. Cole
 1931/32 Jacob D. Heilman
 1932-33 Thomas R. Garth
 1933/34 George T. Avery
 1934/35 Jacob D. Heilman
 1935/36 Thomas H. Howells
 1936/37 Thomas R. Garth
 1937/38 Karl F. Muenzinger
 1938/39 Robert A. Davis
 1939/40 Lawrence W. Miller
 1940/41 Wallace T. Wait
 1941/42 S. L. Crawley
 1942/43 Robert H. Bruce
 1943/44 Robert H. Bruce
 Martha Lou Lemmon
 1944/45 Lawrence W. Miller
 1945/47 William A. Blakely
 1947/48 Thomas H. Howells
 1948/49 Lillian G. Portenier
 1949/50 Lawrence I. O'Kelly
 Karl F. Muenzinger
 1950/51 Theodore H. Cutler
 1951/52 Herbert Klausmeier
 1952/53 Ralph D. Norman
 1953/54 Hugh B. McFadden
 1954/55 Lawrence S. Rogers
 1955/56 Donald D. Glad
 1956/57 Maurice P. Smith
 1957/58 Calvin W. Taylor
 1958/59 Anna Y. Martin
 1959/60 Wilson J. Walthall
 1960/61 Paul B. Porter
 1961/62 Bert R. Sappenfield
 1962/63 Earl. E. Swartzlander
 1963/64 Merrell Thompson
 1964/65 John D. Cambareri
 1965/66 William H. Brown
 1966/67 Wilbur C. Miller
 1967/68 Bernard Spilka
 1968/69 Henry C. Ellis
 1969/70 Ernst G. Beier
 1970/71 John E. Hinkle

University of Colorado
 Colo State Teachers College
 University of Denver
 Colorado Agricultural College
 Colo. State Teachers College
 University of Colorado
 University of Denver
 University of Colorado
 University of Colorado
 University of Denver
 Colorado State College of Educ.
 Colorado State College of Educ.
 University of Wyoming
 University of Wyoming
 Colorado College
 University of Denver
 Colorado College
 University of Colorado
 University of Wyoming
 University of Colorado
 University of Colorado
 University of Denver
 Colo .State College of Educ.
 University of New Mexico
 University of Wyoming
 VA Hospital, Denver
 Univ. of Colorado Med Center
 University of Colorado
 University of Utah
 New Mexico Highlands Univ
 University of Wyoming
 University of Utah
 University of Montana
 Swartzlander & Meyer
 New Mexico State University
 Idaho Department of Health
 University of Utah
 University of Denver
 University of Denver
 University of New Mexico
 University of Utah
 Colorado State University

1971/72 Joel E. Greene
 1972/73 Helen Wilson
 1973/74 Richard G. Weigel
 1974/75 Gregory A. Kimble
 1975/76 Harl H. Young
 1976/77 W. C. Leiding
 1977/78 William F. Battig
 1978/79 Harrie F. Hess
 1979/80 Sheila R. Deitz
 1980/81 David R. Thomas
 1981/82 Michael Wertheimer
 1982/83 Terry C. Daniel
 1983/84 Janet P. Wollersheim
 1984/85 David W. Martin
 1985/86 Nelson F. Jones
 1986/87 David C. Raskin
 1987/88 Lyle E. Bourne, Jr.
 1988/89 Donna M. Gelfand
 1989/90 Lee B. Sechrest
 1990/91 Leonard Haas
 1991/92 Nancy Felipe Russo
 1992/93 William P. Wallace
 1993/94 Joseph Horvat
 1994/95 Alice F. Healy
 1995/96 Beatrix T. Gardner
 William P. Wallace
 1996/97 Mark McDaniel
 1997/98 Paul Bell
 1998/99 Roger Fouts
 1999/00 Elizabeth Glisky
 2000/01 Richard L. Miller
 2001/02 Wayne Viney
 2002/03 Mitch M. Handelsman
 2003/04 Karen Ford
 2004/05 Ross Loomis
 2005/06 Charles Honts
 2006/07 Nancy Karlin
 2007/08 Judith Sugar
 2008/09 Bill Wozniak
 2009/10 Eric Amsel
 2010/11 Pennie Seibert
 2011/12 William Douglas Woody
 2012/13 Wayne Weiten
 2013/14 Steve Barney
 2014/15 Leslie Cramblet Alvarez
 2015/16 Michelle Butler
 2016/17 Eric Landrum

New Mexico Highlands University
 Eastern Montana College
 Colorado State University
 University of Colorado
 Div. of Mental Health, Colorado
 Lovelace Clinic, Albuquerque
 University of Colorado
 University of Nevada, Las Vegas
 Colorado State University
 University of Colorado
 University of Colorado
 University of Arizona
 University of Montana
 New Mexico State University
 University of Denver
 University of Utah
 University of Colorado
 University of Utah
 University of Arizona
 University of Utah
 Arizona State University
 University of Nevada, Reno
 Weber State University
 University of Colorado
 University of Nevada, Reno
 Acting President, U. of Nevada
 University of New Mexico
 Colorado State University
 Central Washington University
 University of Arizona
 University of Nebraska at Kearney
 Colorado State University
 University of Colorado at Denver
 Mesa State College
 Colorado State University
 Boise State University
 University of Northern Colorado
 University of Nevada Reno
 University of Nebraska at Kearney
 Weber State University
 Boise State University
 University of Northern Colorado
 University of Nevada, Las Vegas
 Southern Utah University
 Adams State University
 U.S. Air Force Academy
 Boise State University

RMPA Convention Sites

1930	Boulder, CO	1974	Denver, CO
1931	Greeley, CO	1975	Salt Lake City, UT
1932	Fort Collins, CO	1976	Phoenix, AZ
1933	Laramie, WY	1977	Albuquerque, NM
1934	Golden, CO	1978	Denver, CO
1935	Colorado Springs, CO	1979	Las Vegas, NV
1936	Denver, CO	1980	Tucson, AZ
1937	Boulder, CO	1981	Denver, CO
1938	Greeley, CO	1982	Albuquerque, NM
1939	Fort Collins, CO	1983	Snowbird Village , UT
1940	Denver, CO & Laramie, WY	1984	Las Vegas, NV
1941	Greeley, CO & Golden, CO	1985	Tucson, AZ
1942	No meeting	1986	Denver, CO
1943	No meeting	1987	Albuquerque, NM
1944	Denver, CO	1988	Salt Lake City, UT
1945	Boulder, CO	1989	Reno, NV
1946	No meeting	1990	Tucson, AZ
1947	Colorado Springs, CO	1991	Denver, CO
1948	Greeley, CO	1992	Boise, ID
1949	Laramie, WY	1993	Phoenix, AZ
1950	Fort Collins, CO	1994	Las Vegas, NV
1951	Denver, CO	1995	Boulder, CO
1952	Boulder, CO	1996	Park City, UT
1953	Albuquerque, NM	1997	Reno, NV
1954	Laramie, WY	1998	Albuquerque, NM
1955	Boulder, CO	1999	Fort Collins, CO
1956	Grand Teton Natl Park, WY	2000	Tucson, AZ
1957	Salt Lake City, UT	2001	Reno, NV
1958	Santa Fe, NM	2002	Park City, UT
1959	Sun Valley, ID	2003	Denver, CO
1960	Glenwood Springs, CO	2004	Reno, NV
1961	Albuquerque, NM	2005	Phoenix, AZ
1962	Butte, MT	2006	Park City, UT
1963	Cody, WY	2007	Denver, CO
1964	Salt Lake City, UT	2008	Boise, ID
1965	Denver, CO	2009	Albuquerque, NM
1966	Albuquerque, NM	2010	Denver, CO
1967	Salt Lake City, UT	2011	Salt Lake City, UT
1968	Denver, CO	2012	Reno, NV
1969	Albuquerque, NM	2013	Denver, CO
1970	Salt Lake City, UT	2014	Salt Lake City, UT
1971	Denver, CO	2015	Boise, ID
1972	Albuquerque, NM	2016	Denver, CO
1973	Las Vegas, NV		



86th ANNUAL CONVENTION of the ROCKY MOUNTAIN PSYCHOLOGICAL ASSOCIATION

APRIL 14-16, 2016

RENAISSANCE DENVER HOTEL
3801 QUEBEC STREET
DENVER, COLORADO

Reservations: 1-800-468-3571

DEADLINES:

Submission deadline: January 15, 2016

Convention registration deadline: March 11, 2016

Hotel registration deadline: March 13, 2016

www.rockymountainpsych.org

THANK YOU!

The Rocky Mountain Psychological Association would like to thank the following organizations for their continued support and funding of the RMPA Annual Convention:



COUNCIL ON UNDERGRADUATE RESEARCH



PSI CHI



© 2015

*Design & layout by Rasa Designs
theerasa@gmail.com*

INDEX OF PARTICIPANTS

Adams, Kaitlyn	102	Best, Addie	106	Clark, Michael	46, 117	Dreier, Amy	96
Aguero, Robyn	116	Bigler, Erin	79	Clark, Steven	108	Drwecki, Brian	108
Albat, Marissa	68	Bihun, Joan	57	Clay II, Samuel	88	Drysdale, Lyndsi	98
Albo, Theodore	42	Binette, Auburn	89	Cleary, Anne	41	Dunbar, Nora	21, 22, 68
Allen, Alexandria	95	Blackmond, Laura	44	Clemans, Tracy	100, 115	Duncombe, Kristina	88
Allen, Kelsey	62, 63	Boltz, Spencer	59	Clements, Stuart	29, 118	Eberle, Kiersten	94
Allen, M. Todd	103	Boone, Alexander	40	Clump, Michael	92	Edlund, David	112
Aller, Ty	68	Bote, Luke	50	Coleman, Douglas	67, 69	Eels, Jenna	86
Almonte, Alison	57	Bourne, Stacia	67	Collette, Tyler	20	Egbert, Sadie	60
Aloise- Young, Patricia	110	Bowen, Amalee	49	Colunga, Ana	104	Egusquiza, Jessica	104
Altair, Kat	45	Bradford, Brooke	47	Comstock, Thomas	99	El-Alayli, Amani	53
Alton, Sara	84	Bridgmon, Krista	20, 29, 34, 61, 69, 116	Cook, Chassik	110	Elias, Steven	118
Alvarez, Liliana	59			Cook, Mary	112	Elison, Jeff	47, 48
Ameen, Eddy	27, 69	Briihil, Deb	92	Corbridge, Kasey	97	Engle, Corey	44, 59, 71, 117
Amsel, Eric	23, 24	Broadbent, Cody	50	Coren, Stanley	81	Erickson, Cynthia	56
Anderson, Jennifer	118	Brooks, Malisa	40	Corser, Grant	22, 99, 107, 114, 118	Erpelding, Christina	97
Ansburg, Pamela	21	Brothers, Kortney	107			Evans, Colette	68
Anthenien, Amber	109	Brown, Christina	51	Couture, Sara	91	Ewen, Michelle	118
Ash, Laura	119	Brown, Gina	88	Coyle, Ryan	21, 90	Fallshore, Marte	61, 102
Ashley, Aaron	62, 73, 89	Brown, Josh	109	Craddock, Emily	21	Farley, Remington	67
Augustine, Elaine	66	Brown, Lisa	117	Cramblet Alvarez, Leslie	3, 23, 35, 79, 80	Featherstone, Caley	87, 96
Babbitt, Stephanie	56	Brown, Victoria	102	Crane, Chelsie	60	Felmban, Wejdan	83
Bacca, Anastasia	52, 71, 108	Bryan, AnnaBelle	100	Craun, Elizabeth	56, 67	Fernandez, Kim	62
Badanes, Lisa	38, 52, 59, 71, 108	Bryan, Craig	29, 38, 100, 115	Creem-Regehr, Sarah	40, 90	Findley, Sam	101
				Cross, Allison	25, 55, 105	Fleck Dillen, Bethany	23, 27, 44, 85
Baer, Kevin	106	Bryant, Tyson	54	Cross, Jennifer	110	Flores, Cristina	113
Baggett, Rebecca	53	Brydges, Justine	47	Crowley, Stephen	91	Fontaine, Eva	103
Baird, Kassidy	60	Bumgardner, Jordan	110	Cumella, Edward	21	Foo, Junny	103
Baird, Todd	57, 89, 98, 107	Bushman, Savannah	39	Cunning, Maria	107	Forrest, Krista	71
		Butler, Michelle	57	Dance, Cassie	60	Foster, Danielle	55
Baker, Kurt	96	Bybee, Jordan	89	Daniels, Alexandria	23, 24	Franklin, Maggie	63
Baker, Samuel	96	Caldwell, Brett	101	Davidson, William	63	Frantz, Sue	73
Barhorst, Erica	90	Campbell, Cynthia	70, 84, 93, 109	Davis, Hyrum	102	Freeman, Nahanni	42, 44, 49, 82, 86, 95
Barker, Analise	48			Dawes, Danielle	68		
Barnett, Kaylee	44	Campbell, Pamela	101	DeBerard, Scott	60	Frers, Amy	53
Barney, Steve	19, 63, 81, 92, 101	Canado, Ricky	106	DeCou, Christopher	56, 101	Fritson, Krista	51
		Carbine, Kaylie	88	DeHaas, CodieAnn	47, 58, 103	Frost, Libby	43
Beach, Patrick	91	Cassidy, Kendal	84	Deines, Lane	46	Fulks, James	108
Beasley, Gina	95	Cevering, Colby	43	Delange, Jennifer	21, 108	Furney, Angela	21
Beck, Hall	63	Chao, Ruth	97, 113	Demski, Robert	61, 64, 111	Gahagan, Kassandra	43
Becker, Susan	27, 28, 34, 46, 69, 71, 116	Christensen, Brandi	62	Denison, Jake	118	Gale, Brandon	108
		Christiansen, Lisa	45	Deuser, Meagan	57	Gallither, Renee	48
Bell, Kirsten	108	Christiansen, Matthew	52	Dickinson, Allen	53	Garcia, Crystal	98
Bender, Sara	64	Christoe-Frazier, Liesel	94	Dinehart, Brea	107	Gardner, Nathan	112
Benson, Kimberly	114	Chung, Sarah	106, 112	Domenech-Rodriguez, Melanie	25, 113	Garza, Debani	87
Bessire, Denny	23, 24	Claeys, Roger	117	Dormand, Stephanie	61	Gears, Jonathan	61

INDEX OF PARTICIPANTS

Gee, Eric	108	Hegg, Tara	119	Kelso, Kim	82	Marsing, Nick	29, 53, 60, 102,
Genuchi, Matthew	95, 96	Henry, Kimberly	68	Kirkham, Jordin	112		106, 107, 110,
Georgia, Olivia	110	Hernandez Hassan, Genesis	96	Kitchin, Jannessa	83		112
Ghaffari, Dylan	96	Hernandez, Austin	112	Kittilstved, Wyatt	55	Martin, Javier	105
Gibson, Richard	53	Hernandez, Jovan	97	Klein, Michelle	57	Martinez, Chantal	109
Gibson, Victoria	61, 116	Herter, Whitney	63, 95	Knapp, Jaclyn	57	Martinez, Crystal	62
Gilliam, David	61	Hess, Jacob	64	Knoblock, Alexandra	60	Maurtua, Savanah	109
Glenn, Kelli	25, 55, 105	Hester, Casey	55, 105	Kole, James	21, 40, 91	Maxwell, Ian	108
Gonzales, Cassandra	87	Hettich, Paul	92	Kourbanova, Kamila	65, 103	May, Scott	84
Gonzalez, L. Andre	52	Hiatt, Matthew	88, 106	Kranz, Peter	22	Maylett, Cameron	107
Gonzalez, Bianca	44	Hicken, Chelsey	108	Landa-Ferron, Krystal	53	McCall, Rona	27
Goodman, Elizabeth	99, 107	Hicks-Collins, Trevor	64	Landrum, R. Eric	18, 27, 73, 92	McCarthy, Maureen	73
Goodman, Joseph	99, 107	Hill, Jessica	25, 84	Lane, Carrie26,	51, 64, 99, 111	McCarty, Kelly	52
Gordon, Winford	25, 55, 105	Hill, Karlie	64	Laney, Cara	51, 55, 60	McClannahan, Celeste	24, 112
Goring, Sara	40	Hill, Katherine	47, 90, 91	Larisch, Torrey	107	McDonald, Tyler	42
Graff, Tyler	82	Hilwig, Stephanie	47	Larson, Kalina	55	McEntire, Luke	24
Grayston, Carly	106	Hinkson, Kent	39, 100	Lavin, Kelly	97, 98, 113	McGillivray, Shannon	53, 54, 55, 56,
Grebert, Tara	64	Hofmann, Sara	110	Lavooy, Maria	28, 71, 116		98, 99
Greene, Meghan	95	Holbrook, Elizabeth99		Lee, Alicia	54	McGourty, Kimberly	66
Gregory, Bradley	92	Honea, Chelsea	26	Lee, Yoon	66	McKeever, Amanda 57	
Griffith, James	100	Honts, Charles	19	Levy, Patricia	20	McKinley, Steve	46, 69, 71, 117
Griffiths, Todd	112	Horvat, Joseph	112	Lewis, Natasha	96	McManus, Jessica	70
Grigg, Laura	25, 55, 105	House, Donald	40	Lindgren, Drew	91	McNaughton-Cassill, Mary	100
Griggs, Jennifer	103	Howell, Kelsie	52, 71	Liss, Hannah	117	Mecham, Weston	110
Grimm, Marshall	67	Hubbard, Charice	58	List, Elizabeth	57, 69, 101, 104,	Medlin, Mary	63
Grimsley, Fred	47, 58	Huggins, Josiah	68		116	Meier, Steven	72
Grogan, Czarina	42	Hunt, Joshua	54	Lloyd, Bradley	99, 106	Melchior, Lis	60
Grover Seiver, Jillene	85	Hyde, Jordan	88	Lloyd, Carly	62	Menghini, Michaela	71
Gudjenov, Christyan	111	Ihle, Christopher	97, 98, 113	Lockwood, Linda	21, 84, 86, 92	Merrill, Luke	116
Gutierrez, Laura	102	Imel, Zac	100	Lofthouse, Ryan	60	Metz, Marissa	41
Haight, Courtney	56	Jacquez, Nathan	59	Lynch, Shannon	101, 102	Meyer, Cara	55, 105
Hamilton, Heather	44	James, Lori	41, 80	Lyons, Kristen	52, 59, 71	Millar, Murray	45, 50
Handelsman, Mitchell	26	Jensen, Chad	88	Lyons, McKenzie	91	Miller, Amanda	52, 55
Hardwick, Danica	61	John, Cameron	39, 40, 42, 47,	Lyster, Sara	69	Miller, Chazlyn	59, 70
Hardy, Kimberly	63, 91, 95, 120		82, 89, 111	Mace, Britton	29, 118	Miller, Richard	20, 22, 23, 65,
Harman, Jennifer	109	Johnston, Adam	24	Machlev, Moshe	54, 85		78, 87, 113
Harris, Wesley	106	Jordan, Kerry	73	Macias, Rosana	99	Minear, Meredith	68
Haschke, Katelyn	51	Jump, Megan	43	Madera, Margarita	113	Miner, Mari	25
Hatch, Daniel	29, 60, 96, 97,	Kaplan, Stephanie	56, 69, 102	Maez, Jennifer	111	Moon, Jordan	50
	114	Karlin, Blake	58	Magleby, Spencer	97	Moore, Claressa	55
Haug, Rachel	110	Karlin, Nancy	38, 42, 54, 58,	Mallory, Patrick	50	Moore, Dorothy	102
Haugen, Kristie	90, 109		83, 85, 118	Mann, Timothy	44	Moore, Erin	60
Hayes, Ashley	89	Katayama, Andrew	57	Mares, Michael	101	Moore, Jessica	59
Hayes, Kimberly	63, 66, 91	Kay, Theresa	89, 112	Marino, Elizabeth	64	Moore, Lauren	66, 70
Heath, Travis	119	Keehr, Jode	92, 99	Marino, Nathaniel	65	Morales, Kristie	86
Hegarty, Mary	40	Kelley, Gwen	92, 99			Moreno, Lauren	65

INDEX OF PARTICIPANTS

Moreno, Olivia	114	Pritchard, Mary	59, 87, 91	Schmidt, Matthew	107	Taylor, Teresa	120
Morton, Sarah	103	Pyszczyński, Tom	34	Schottelkorb, April	95, 96	Terry, Steven	52, 59, 71
Myers, David	36	Radeke, Mary	83	Schroeder, Michael	38	Thompson, Sharlynn	58, 91
Myra, Darty	72	Rakeen, Bahroze	97	Schultz, Zach	50	Thompson, William	40, 90
Nebeker, Danielle	47, 58, 103	Rand, Kristina	90	Schwickert, Carly	70	Thurston, Ashlee	43
Nelson, Alexis	49	Randell, Chrislyn	27, 29, 45, 48,	Segrist, Dan	92	Tibbitts, Camille	91
Nevins, Cody	60, 97		84	Seibert, Pennie	47, 58, 103	Torres, Jennifer	55
Newton, Kelsy	45	Rasmussen, Claudia	112	Seiders, Jennifer	116	Trenary, Melanie	44, 84
Nicholson, Zania	114	Rea, J'lene	56	Seloske, Benjamin	52	Tubbs, Blake	54, 62
Nielsen, Logan	102	Reardon, Richard	92, 99	Sewell, Anna	50	Tucker, Tavinia	111
Niemela, Danielle	114	Reber, Jeffrey	88, 106	Sferrazza, Alyssa	59, 70	Ulibarri, Carley	58
Nolan, Susan	73	Reynolds, Larissa	63, 118	Sharkey, Amber	107	Ullman, Joanne	53
Norwood, Sabrina	68	Reynolds, Mira	100	Shilling, Aaron	51	Vaterlaus, J. Mitchell	43
Nosek, Brian	35	Rhomberg, Parker	97, 98, 113	Shumway, Scott	97	Venn, Bethany	51
Nystad, Ingrid	60, 87	Richmond, Aaron	20, 22, 71, 84,	Silver, N. Clayton	53	Vernon, Nannette	112
O'Leary, Aishia	51		85, 92, 117	Simon, Alex	108	Vik, Peter	104
O'Halloran, Sean	96	Ricketson, Timothy	109	Sitz, Lindsey	44	Villanueva, Samantha	90
Oberhansley, Trevor	102	Ridge, Katelynn	44	Sitzman, Danielle	55	Vittum-Jones, Alex	118
Olivas, Gabriela	119	Riffel, Sarah	104	Skewes, Monica	59, 70	Waddell, Benjamin	47
Olson, Michael	108	Rings, Jeffrey	94	Sleight, David	54	Wadkins, Theresa	46
Ombach, Hendrik	56, 98	Roberts, Holly	56	Smart, Shea	84	Wainry, Cecilia	67
Osman, Augustine	100	Roberts, Susan	103	Smith, Hilary	100	Walker, Brice	99
Oswald, Brianna	93	Robertson, Evan	42, 86	Smith, Randy	21, 44, 45	Walker, Keegan	82
Owens, Emily	58	Robinson, Emily	50	Smith, Savannah	61	Walsh, Mandy	45, 50
Pace, Brian	100	Rocheleau, Courtney	39, 72, 82, 87	Soelberg, Kayla	23, 24	Ward, Diana	87
Padilla, Lace	40	Roggman, Lori	66, 68	Softas-Nall, Lia	110	Warden, Alexis	21
Palmer, Ty	39	Ropp, Anna	36, 44, 72, 82	Softas-Nall, Sofia	110	Warne, Russell	40
Papa, Lester	119	Rosa, Juliana	68	Spaugy, Tara	96	Warner, Ruth	51
Park, Su Jung	66	Roseberry, Drema	71	Spencer, Nicholas	82	Weaver, Jacob	53
Parsons, Lauren	61, 116	Rosenblat, Adriana	89	Stahelski, Anthony	83	Weaver, Jennifer	62, 65, 66, 67,
Patterson, Christina	25, 113, 119	Royal, Christina	65	Staker, Kaitlin	98		70
Patterson, Michael	109	Roybal, Dariana	111	Staley, Shelly	41	Weil, Joyce	83
Paul, Jeffrey	88, 94	Rudzinkas, Christine	44, 117	Standley, Corbin	98, 112	Welsh, Ashlee	82
Pearce, Camille	63	Ruginski, Ian	40	Staut, Mitchell	42	Westfall, R. Shane	45, 50
Pease, Katie	96	Rushton, Kevin	112	Steadman, Riley	106	Wheeler, Lindsay	117
Perkins, Randy	110	Rust, Teri	52	Stevens, Rick	63	Wheelwright, Matthew	53
Perschon, Bailey	102	Sadrija, Aferdit	87	Stevenson, Olivia	94	White, Kirsi	115
Petersen, Chelsey	110	Salazar, Benjamin	38	Stirland, Jared	82, 89	White, Lynn	22, 43, 49, 59, 87
Petersen, Devin	38	Saleme, Farah	63	Strain, Lauren	64	Whittaker, Kelton	60, 92, 114
Pfeger, Isaac	54	Sanders, Cheryl	43, 50, 83, 84	Stratford, Andrew	112	Whoolery, Matthew	54
Pfeger, Jacob	54	Sanders, Jacob	50	Streeter, Geoffrey	46	Widdison, Cassie	112
Platsidou, Maria	110	Sandoval, Perla	110	Strosser, Garrett	52	Wiggins, Aryanna	39
Plum, Lara	44	Schatz, Robert	43, 48	Sugar, Judith	29	Wiggins, Brady	22
Pope, Elisa	85	Schell, Rhianna	43	Sullivan, Roxanne	22, 28	Willemse, Isai	106
Potter, Kaitlin	29, 118	Schenck, Laura	94	Taku, Susan	87	Williams, Catherine	104
Pratarelli, Marc	90, 109	Schenkelberg, Rita	46	Talley, Jared	91	Williams, David	103
Prater, Kayllie	71	Schmank, Christopher	41	Tanaka, Chikako	62	Willow, Katrine	43

INDEX OF PARTICIPANTS

Wilson, Dakota	107
Wolfe, Andrea	100
Wolford, Jessica	62
Wolken, Talia	97, 98, 113
Wong, Maria	67
Wong, Rachel	26
Woodbury, Eric	112
Woodruff, Jason	112
Woods Roberts, Barbara	69
Woody, William Douglas	18, 20, 22, 42, 78, 88
Wormley, Katy	105
Wozniak, William	46
Wright, Kelly	85
Wright, Emily	82
Wright, Robert	50
Wright, Stephen	95, 96
Wucherpfennig, Andrea	48
Wuertz, Tara	105
Yamawaki, Niwako	112
Yoder, Amanda	96
Ytterberg, Maria Jose	44, 117
Zeff, Courtney	50
Zhang, Ying Shan Doris	97, 98, 113
Zhao, Clare Jinzhao	97, 98, 113
Zimmerman, Christian	47, 58, 103
Zook, Theresa	44
Zschau, Toralf	114



Rocky Mountain Psychological Association
www.rockymountainpsych.org